

DNH1

For
OSR and 5th Edition
Games

Part one of the
Haunting of Hastur Series

The Lost Temple of Forgotten Evil

by L. Kevin Watson

An Adventure for Characters Levels 4-6



The Lost Temple of Forgotten Evil is an adventure for 3-7 characters level 4-6 and designed for use with most versions of the best known fantasy roleplaying game. It is optimized for the fifth edition and for 5 characters at level 5.



Dark Naga Adventures
Awesome is in our DNA!
© 2016, All Rights Reserved



Printed in USA

The Lost Temple of Forgotten Evil



DNA1: The Lost Temple of Forgotten Evil

Dark Naga Adventures

Written: L Kevin Watson

Illustrated: Rick Hershey

Cartography: Alyssa Faden

Editors: Claudia Johnson, Jonathan Biedron

Production and Layout: L Kevin Watson

Proofreading: Jonathan Biedron

Playtesting: Door Kicking Death Dealers

Publisher's Choice Quality Stock Art © Rick Hershey / Fat Goblin Games



Open Content: Subject to designation as Product Identity (see below), the only portion of this Dark Naga Adventures product designated as Open Game Content is the rules content (creature stat blocks and names of skills, etc., taken from the *System Reference Document 5.0*) as defined in the Open Game License version 1.0a Section 1(d). The front and back cover, back matter, introduction and Credits page, as well all other parts of this product including all text not specifically designated as Open Game Content is not Open Game Content. No portion of this work other than the material designated as Open Game Content may be reproduced in any form without written permission.

Product Identity: The following items are hereby identified as Product Identity, as defined in the Open Game License 1.0a, Section 1(e), and are not Open Content: The following locations, their maps, drawings, and description: Duchy of Lagduf, Kingdom of Meawold, Sea of Dince, Boldon, Sumer, Maria, Pinto, Woodbluff, Baramunz, Owford, Porthy: The following characters, their likeness and description: Count Gylip, Duke Raffolk, Duke Gauward, Duke Eandald, Duke Bertio, Cyne, Edmur, Finy, Tane, Thamas, Jopha, Kreil, Jennavieve, Vnycis, Tanfleue, Saraq, Fredu, Wulfa, Rancent, and the historical events: The First Age of Man, and The Second Age of Man

Reference in non-Open Game Content (thus not covered by the Open Game License) in this work to content owned by others is not a challenge to their ownership and is used under Fair Use.

Introduction

The Boldon region, a small town and its surrounding villages, is afraid. Dozens of people are missing, some speculate lost to some nefarious purpose. Tales of an evil temple and the horrible things within circulate. The few who know the legends and history of the region are beginning to think the dark times have returned; not seen since the fall of the first age of man. People are beginning to feel the icy fingers of fear closing in. Upon arrival, the party encounters a broken man, a homeless drunkard prone to incessant rambling. This inspires an investigation into the stories of a lost temple. Has it been rediscovered by men seduced by its forgotten evil? The drunkard's tale leads to others who might help the party discover more before they face The Lost Temple of Forgotten Evil.

Campaign Integration

The area near the temple is designed to be woven into your world with minor modifications. The adventure is set along the coast of the Duchy of Lagduf, within the Kingdom of Meawold. Boldon, a small town that supports several farming and a few fishing villages, is the hub of the region. Sumer is a small fishing village on the Sea of Dince that could easily be on the shore of a large body of water in your world. Maria and Pinto are farming villages.

The villages are a half-day walk or a quarter day's ride from Boldon. They are more or less evenly spaced around Boldon. The distance between them keeps relations amiable. This region should drop into any world with small adjustments or be made part of some other fiefdom if that fits your world better. Meawold and Lagduf are lightly-sketched. Boldon, Sumer, Maria and Pinto are more detailed, providing as an open-ended campaign. Over 1,400 years of history and lore, are provided.

For the GM

Fredu's tale starts the adventure and is the focus during the first act. The subsequent delve into the temple, the other focus, can be taken in a timeframe comfortable to the party. Six non-linear, optional quest components are detailed between the foci – making an ellipse that ties the components into the adventure.

The Lost Temple of Forgotten Evil is composed of eight major encounter areas, meeting with Fredu, three optional encounters in Boldon, and one optional encounter in three of the larger villages and the temple. With regard to the optional encounters: Two of the encounters are intended to be combat, two of them are intended to be solved with role-play, are two of them could be resolved by combat or role-play at the discretion of the party.

The adventure design is intended to balance between distinct differences in player methods and styles of play. Keeping goals non-linear and no event or encounter a necessity gives parties have maximum flexibility. The players can complete or skip the encounters as they see fit, may tackle them in any order, and can walk (or run) away when overwhelmed. With each successful encounter, leaves them more prepared for the dungeon.

The six encounters reveal:

- The location of a secret door
- Instructions to open the secret door
- Needed supplies
- Map A – player map of the temple
- Map B – player map of temple location
- Insight on the ancient magic of the temple's priests

Name	Role and Population	Location
Boldon	Town of 4600	Center of the region
Sumer	Fishing village of 1100	About 9 miles NW of Boldon
Pinto, Maria	Farming village of 1300-1400	About 10 miles from Boldon

Background

Fall of the First Age of Man

The Duchy of Lagdulf and the Kingdom of Meawold sprang from the ashes of the previous age of man. Well over a millennia ago, temples of the dark god Hastur ruled. From the shadows, they spread like wildfire to every town in the land. Many dismissed the followers as a harmless cult and made excuses for reported misdeeds. Nobles were corrupted by promises of power, while the innocent were sacrificed to the dark god. No city was spared the temples. Leaders either submitted or were overrun.

The corrupting influence all but engulfed the kingdoms of man. In this bleak era, some men were forged into heroes. Backed by a large army of elves and a ragtag force of dwarves and halfings, the forces of good snapped from their delusional state to face the encroachment of darkness upon their world, and the fight to drive out evil initiated. Over the course of three generations, light gained on darkness as good conquered evil. Men, elves, dwarves and halfings banded together and steadily drove back this plague of Hastur and his corruption.

Once the evil was conquered the alliances dissolved, the races of the world returned to their petty bickering. Celebrations gave way to decadence, and eventually man forgot what had once made him prevail and descended back into darkness.

The First Age of Man ended with the collapse of civilization only a few centuries after conquering the evil of Hastur. In the millennium of chaos and darkness that followed, the population of man in the Boldon region dwindled as nature reclaimed it. For the next 700 years, civilization would remain elusive. There were many sparks, but none would ignite to become a beacon in the darkness.

Rise of the second age of man

Men of vision banded together to form something enduring. Starting some 300 years before present, civilization took root, grew steadily and survived a few generations. The Kingdom of Meawold formed and expanded. After a century of astonishing recovery, Duke Raffolk was presented a duchy within Meawold, Lagdulf. He soon launched an ambitious initiative to tame his duchy and to transform it into a grand and prosperous place. Duke Raffolk was succeeded by his grandson,

Duke Gauward, who founded the coastal town of Boldon. With Boldon at the hub, two fishing villages and five farming villages formed, with hundreds of small independent farms in the surrounding region.

Thus, the duchy was supplied with foodstuffs and an additional market for trade goods and thrived for a quarter century until it was rent by a devastating earthquake. The farms and fields were decimated by the earth's shuttering, and the peaceful seaside villages were drowned beneath the ensuing waves. Fires and aftershocks further reduced the region to rubble.

The mayor of Boldon, Wulfa, rebuilt the region with his own architectural and managerial flair. The practice of specializing in specific crops was discontinued, and diversification was adopted to strengthen independence from external supply lines for the village and the region as a whole.

Integrating with Starting Adventures and Starter Sets

This adventure assumes the players are already level 4-6. Most starter sets take the party to level 3, some to level 5. If you are starting a new party intent on running this adventure, and your starter set advances the party to level 3, you may find it necessary to provide some side adventures to advance them to level 4, or a bit more, before starting this adventure. This can be done by dropping in some level appropriate side encounters as the party heads from their starting location to the Boldon Region.

Most starter sets and introductory adventures are vague beyond the specifics necessary for the adventure. The end effect is they can be easily inserted into your world or published settings. The Five Kingdoms setting is similarly flexible and can accommodate most low level adventures.

Today, Boldon exports foodstuffs to Lagduf and imports items useful but not vital to the region's survivability such as minerals, metals and luxury items. Lumber, abundant in the duchy, is harvested and consumed locally; rarely traded. The Duke of Lagduf, Eandald, initially felt threatened by this fiercely independent streak, but his son, Bertio, leaning on his Meawold education, recognized the duchy's inhabitants as men of the earth, completely loyal to the Duke forged by tragedy. They had organized their lives and community to survive the next disaster. When Wulfa was apprised of Duke Eandald's concerns, he worked tirelessly with Bertio to alleviate all misgivings. Duke Bertio is now the ruler of Lagduf, his father having passed a score of years after the earthquakes.

The earthquake's resulting upheaval exposed an entrance to a temple of Hastur, which had long ago been obstructed by the armies that purged the cult from the region. Undiscovered for decades, the orifice was inadvertently discovered three years ago by Fredu, a man lost in the forest.

Fredu's Encounter

Fredu, a farmer who was taking a shortcut from Pinto to Boldon, became startled by animal noises. Running through the rocks and trees, exhausted and barely able to see in the dim moonlight, he sought shelter in an opening in rocks. Believing he had found a small cave to protect him from becoming dinner for some hungry beast, Fredu began to crawl, making his way to the deepest part of the crevice. There, Fredu discovered that the opening linked to a stone passage. By the light of a flickering torch he fashioned from materials within the temple, he found himself surrounded by horrifying images. The most terrifying was a statue of Hastur. Stricken with fear, Fredu ran for his life – ran home to Pinto to tell his story.

Yet, the humiliation and ridicule of the disbelieving townsfolk drove him to despair and finally to drink. As the months wore on, he sold everything he owned to numb his addled and fear-enslaved mind from relentless reproach and nightmarish memories. Fredu is a drunkard and now recounts his night of terror to all who will listen – with the right enticement. Recently, he has taken to telling a comic variation of his story in trade for drink. Once a productive farmer, he now takes odd jobs and tells his tale in exchange for some shelter, a little food and copious amounts of booze. This has made him a manipulative and

unreliable storyteller prone to fabrication to nurture his habit.

Some of Fredu's listeners entertained their own dark plans.

Cyne's Seduction

One who heard Fredu's tale is Cyne, a priest of light local to Boldon. Cyne became driven, his thoughts focused on the destruction of the temple's evil. His mind clouded by rage, he disregarded good judgment and immediately sought the temple. Unprepared and without allies, Cyne's weakness was easily discerned by Hastur. Cyne was easily corrupted – seduced by the trappings of power, control and riches.

Cyne gave in to temptation and has become a dark priest of Hastur. He has recruited adepts,



Fredu, Always Ready With A Story

restored the temple and began to spread the dark influence of Hastur. He plans to corrupt the Duchy and eventually the Kingdom. Becoming a dark priest of Hastur took several months. Recruiting followers took a few months. Restoration of temple took the better part of a year. The material for the dark crimson heavy woolen curtains that line most of the walls took a great deal of effort to acquire. However, along the way, Cyne found like-minded people to bring his complement of cultists to 40, a number that pleases Hastur. (The cultural equivalent of the number 42 for Douglas Adams fans.)

In recent months, there have been disappearances of locals to the region – 315 total so far. Some were abductions; some were cultists or those attracted to a dark power. Others simply had mishaps while off the well-traveled roads and were never found. With a significant portion of the region's population unaccounted for, people are beginning to speculate that Fredu's impossible tale may have some truth to it. Perhaps he did face the dark god. Perhaps



Cyne, Priest of Hastur

the door to the temple is truly ajar. Recalling the legends from the First Age of Man, people are no longer able to dismiss the threat of evil and ignore the ramifications of Hastur unleashed.

The party's initial encounter with Fredu precipitated the journey that may end *The Lost Temple of Forgotten Evil*.

Potential Player Hooks

- The party might be a mixture of people who started in small towns like Boldon, left seeking their fame and fortune in the world beyond
- They were asked by a patron or other contact to investigate the troubles.
- This may involve an assignment by the contact, or come from the enticement of a reward.
- Example: Edmur, a member of the Meawold Court has hired the party to follow up on a rumor of some kind of trouble in Boldon with a promised reward of gold, and recognition
- The players could be from the Boldon area and decide or be tasked to investigate the troubles.
- The players could be from another part of the kingdom and be sent to Boldon to help with the troubles.
- The players could be guarding a caravan that is bringing ore to Boldon and decide to look into the troubles.

About the Boldon Region

The Boldon region is about 30 miles across (~780 square miles), with about 15 percent being the Sea of Dinse. This leaves about 660 square miles of land. The land today is about half virgin forest, a quarter farmable land and the balance unusable land, including rivers, streams, rocks, bad soil, the upheaval from the earthquake, etc. The area is growing rapidly to feed a hungry duchy, which has a current population of 10,483.

The region is a thriving community on the fringes of a large duchy and part of a large kingdom along the coast of the Sea of Dinse. Boldon forms a hub for a wheel of farming and fishing villages. The region has a population of about 2,100 families with more than 800 families living in Boldon. The balance of the regional population is distributed across a couple of hundred standalone farms and seven relatively large villages, including two fishing villages and five farming villages, each with

about 125 families. Dozens of smaller villages are comprised of three to five families each. The large villages are each roughly 10 miles from Boldon and between six and 10 miles from the next large village along the rim. These villages all look to Boldon for trade, defense and other support.

Boldon

Boldon is the hub of a cluster of agricultural and fishing villages and standalone farms. The villages of the region include the fishing villages of Sumer and Woodbluff and the farming villages of Baramunz, Maria, Owford, Pinto and Porthy. Another hundred or so standalone farms exist in the region. The villages and Boldon engage in some light textiles, metal work and woodworking.

Boldon's small size is reflected in a unique religious cooperation. Priests of three faiths (or four depending on your world) in the area work together and share worship space because the community is too small to support the churches individually. The GM should include a faith of light and something druidic when fitting the region into their world. Boldon sees a lot of trade traffic from the villages and from the core of the kingdom. The residents are not particularly bothered by strangers.

Fruits, vegetables, grains and meat are brought into Boldon and then on to Lagduf from the surrounding villages. Ore, finished goods and refined textiles flow into the region from elsewhere in Lagduf. Lumber is harvested and utilized locally. Following the earthquake and subsequent devastation, Wulfa changed the way the region was organized to help it survive future catastrophes. The region is largely self-sufficient, receiving mostly non-essential goods from the duchy.

Sumer

Sumer is a fishing village of nearing two hundred boats, and about one hundred and thirty families, and the home of the only herbalist in the region that has the skill to brew potions. He moved his family and trade to the coast in hopes that the salt air would help his ailing daughter breathe more easily. Sumer's buildings are primarily densely packed on the beach facing side of a large hill across four steppes. Caravan office, tavern, support businesses and other trade buildings are near where the boats are beached after their harvest. Residents of Sumer see themselves as hard living sea folk, and take a while (at least two rounds of brew) to warm up to strangers.

Maria and Pinto

Maria and Pinto are farming villages. Each village square is lined along one side by a caravan office, an outpost of the Boldon watch, general stores, shops and a large pub. Behind these are the workspaces and shops of the other tradesmen of the village. Two of the other three sides are lined with farmers' homes. The remaining side of the square funnels into the road out of town. Most farmers have small cabins or huts to support and shelter the workers near their fields. A few of the farms raise livestock, but most are agricultural. After the earthquake 60 years ago, Wulfa, Boldon's Mayor, had a strong influence on how the villages were planned and rebuilt. The larger farming villages are half way between the xenophobic small villages and the indifferent residents of Boldon. The party will experience a wide range of receptions from Maria and Pinto residents.

The Tale of Fredu

Virtually all of the residents of the city of Boldon know Fredu. When the subject of the disappearances comes up in conversation, most will inevitably mention him and his fantastic tale. Some, such as Finy, the captain of the watch, and Tane, the mayor, will be more direct, and suggest that inquiring parties talk to Fredu, as they have begun to suspect the presence of truth in his tale. They will also mention that his stories have gotten more fantastical over the years.

Unless he can wheedle an occasional odd job that provides lodging, Fredu usually sleeps (as best he can) in the alleys while in the city of Boldon. If the party were to observe some of his tormented sleep and somehow translate his screams, the words would mostly be an indecipherable jumble, with occasional comprehensible phrases such as "after so long," "I am awake," "convert new followers," "sacrifices to restore," "I will give you power," etc.

By day, Fredu is usually found in the local taverns trying to tell tales in exchange for drinks. He likes to approach strangers who have not yet grown tired of hearing his tale. Fredu would like to receive six pints of ale to tell the story.

The first time Fredu tells his tale to the party, he will be himself and will tell the 'true' version. Though the dark agent within his brain is aware of everything that Fredu does, Hastur desires that they hear the tale. He hopes they will be enticed to investigate, as the capture and sacrifice of adventurers of such level will greatly assist in the

final restoration of the temple, and he believes the party will not be missed nearly as much as any locals, of which he has already sacrificed many.

Fredu's tale should make the party aware of the six optional encounters and of the temple itself. Here is one possible telling of the tale.

Ideally, the interactive encounter that is "Fredu's Tale" should have him reluctant to talk about that night and have the party draw more information out of him. Players may want to use ability checks, skill checks or spells to help draw out the information and see if there is a way to magically or divinely help the broken man.

I have provided one possible solution to this, but there are many other possible solutions. This is not meant to be a morality adventure about the evils of alcohol. However, compassionate players may see Fredu as a victim of the evil and want to undo its grip on him. There is no flaw with that argument, and players so inclined should be recognized for great role playing.

Fredu's Tale

Key Points

- He was out in the country lost, heard some noises that frightened him, ran and ended up stumbling into a cavern. (The cavern was unearthed by the earthquake, but remained undiscovered for more than a generation)
- The natural cavern gave way to finished stone, which led to a temple that held horrifying images.
- Fredu ran home after a long, horrifying night in the temple and made his way home to his village (Pinto).
- Since then, he has told his tale to many people and remained drunk for as much of the last three years as possible. Among those who have heard the tale are:
- Cyne: A priest from whom Fredu sought help with the nightmares that eventually led to his drunkard ways.

- Thamas and Jopha: Fredu traded his tale for a few casks of ale from Thamas, who took detailed notes and interrupted the tale to ask too many questions. Jopha soaked up all without saying a word but asked Fredu to verify the accuracy of a map of the temple interior that he sketched. Additionally, Thamas drew a map of the temple's location.
- Fredu found a scrap of parchment on the floor and kept it when he left. It was written in a strange language.
- Fredu traded the scrap to Kriel for booze in an effort to stay drunk. Kriel said it contained a secret of the temple.
- Fredu has not connected these events with the disappearances that began two years ago.

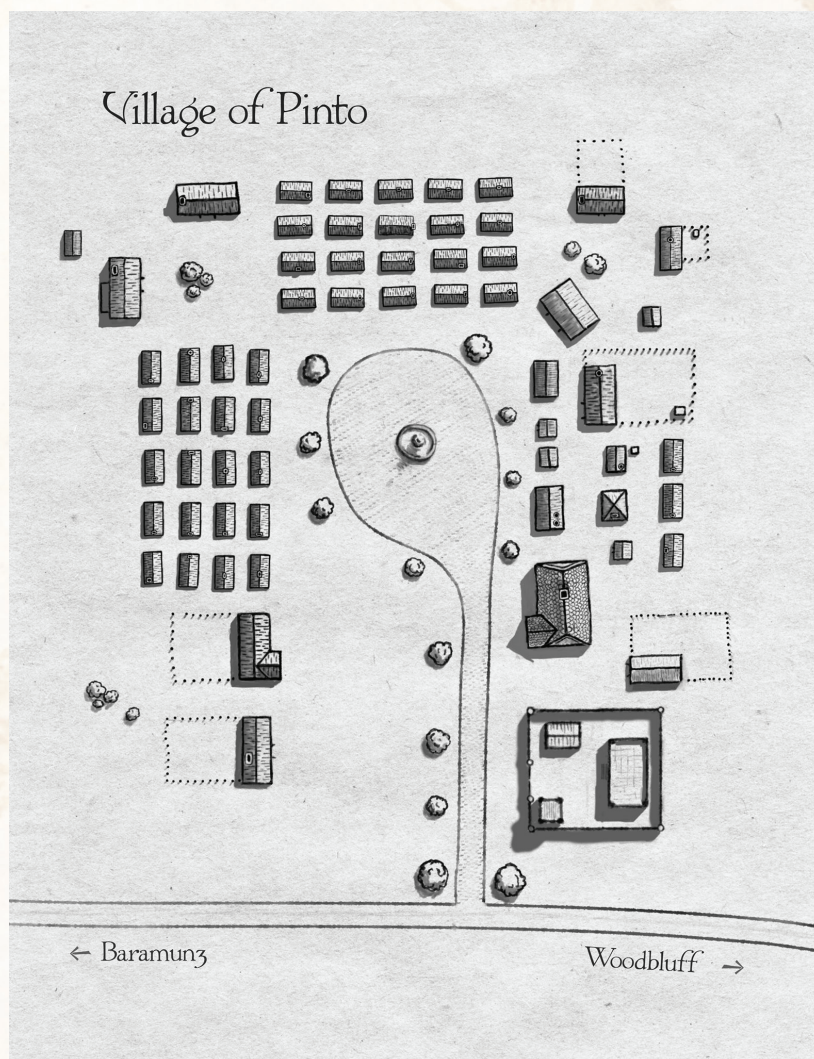

Monologue

"That night. Ya wanna know about that night? Oh it's a good tale. I'll curdle your milk and make you glad you ain't old Fredu. I'll gladly tell you my tale for six pints of ale. Such a small price for such a lamentable tale of woe. And it's all true.

It was maybe three years ago. I was coming from my home in Pinto; I needed to get my chickens to Boldon. But I was going to be late, you see. So like an idiot I cut through the Badlands to save time. Now I know better. Everyone always knows better. A mile or so in, I ran into this pack of wolves, all yellow eyes and teeth. I just dropped that sack o' chickens and the beasties tore into 'em. But some of them beasties started looking at me like I might be the biggest chicken they ever seen. So I just took off running. Over rocks, through the bushes, getting all torn up. I ran and ran, and eventually I realized I was lost with the sun starting to set. Lucky me I think as I found a small cave. It was nearly dark as I slipped into it on my hands and knees, feeling for the back of the cave. After a while I found some parchments and a little jug of oil and improvised a torch. It took some work, but I was able to light some wood. I managed to keep some of them parchments too. They had some wild writings on them, like nothing I'd ever seen.

Anyway, I see the cave gives way to a flat, worked floor. Still covered in rubble, but not natural rock. Like the floor of a castle. Eventually the rubble became just dust. I must have been two hundred feet from the mouth, and eighty or so feet past where the finished floor began when I figured I was in some kind of underground tomb. And I think maybe I can liberate some dead guy of a gold ring or something. What would he need with it? He's dead! The tunnel was really carved near the floor on each wall. Detailed work, like dwarves or something.

As I went through that tomb, I saw things on some of the walls that were horrible, really made me shake. But I just kept thinking: tombs got gold, so much easier to get than from selling chickens. So I went deeper. Finally, I see this statue. And I start hearing something, buzzing, whispering in the back of my head. And I realize this ain't no tomb, it's some sort of temple. The sort that's the worst kind of evil. I felt ... no, I knew that terrible things had been done in that place. Crimes against nature. Sacrifices.... Heard a man say once to be wary of looking into the abyss, because when you do, the abyss looks into you too. He was right.

I turned and ran. I got lost in that temple, trying to find my way out. My torch went out. Crawling on my hands and knees, pleading with my god, any good god, to silence the noises in my head. Finally I found the way out, through the tunnel and the rubble. By the time I got to the

cave mouth, it was daybreak. I headed home. All the way to Pinto, I walked.

After that, the terrible nightmares started. They won't let me sleep! My family says I'm smashing about in the night, and screaming something terrible that they can't understand. They think I've been possessed by a demon. And they run me right out of the farm! Tell me never to come back. So Fredu's got no home to go to.

I go to Boldon, to Maria, all the larger villages, telling my story, trying to find someone who can stop the noises. Almost no one will help. They all laugh at me, say I'm crazy. The first one who really listened to me was Cyne, a priest here in town. He said he would help deal with it, called it "the evil," but the nightmares and the whispering in my head never stopped. I guess he was sent back to the head temple in Lagduf for additional training or something, maybe because he didn't help me like he said? I'm not sure. I ain't seen him for a couple of years now. Anyway, the only thing that stops the noises in my head is the drink. So I start drinking, and I ain't never stopped since. For six pints, you are getting off easy.

Kreil, he gave me a lot of ale and wine for my story! Course he also wanted those lambskin parchments in exchange, the ones I kept, cause they had those writings on them. Turns out he was fascinated by the writing, said it could be some sort of secret from the temple. Being a sage, he didn't pay out the price for my weird little scrap all at once. Still, he helped get my brain nice and quiet. For a while at least. I wish I had more o' them little scraps for Kreil. He is wise, but values the strangest things.

About a year ago, Jopha, he gave me all of the ale out of a little keg. He makes the bows and arrows here in town. Anyway, he looked real bored ... until I got to the part about the carved passageways. Then he got real interested. He pulled out a parchment asked me to describe parts of that temple again and again, asking about doors and carvings and rooms and such. He kept showing me the map he was drawing, asking me to let him know if what he sketched looked right. I don't know why he was so interested. I don't think he ever went there. But that keg kept me in drink for a while.

Recently, Thamas, from my old home of Pinto, paid me in drinks for a whole week! He asked a lot of questions, kept interrupting my tale. Was doodling the whole time. Turns out he was sketching a kind of drawing of the area, trying to figure out where the cave was from what I was telling him. Didn't say what he wanted it for though."

He licks his lips and downs the fifth pint of the ale you bought him and eyes the sixth.

If asked about the disappearances, he has not heard of them. And he sees no connection between the temple and the disappearances.

It would take about 2-3 sp per night to keep him drunk enough to quell his nightmares for as long as his new patrons might want to help him.

To cure him would require a series of restorative spells, cast daily for a month. This will free him from the trauma and its lingering impact on his life. Another option would be "Greater Restoration" cast three times over a period of 8 days.

If freed from the nightmares and subsequent alcoholism, Fredu will eventually rebuild his life, and become a productive member of the Boldon region again. He will not make his new life in Pinto, he will opt to resettle as far away from the old temple as possible.

If he is left as he is now, he will be dead within a year. Each player who participates in curing Fredu should receive 300 additional XP.

Fredu is not as much of a drunk as he appears. His encounter with Hastur had more effect than he can possibly imagine. He is of two minds; one the drunk, the other an agent of Hastur. When he is controlled by Hastur, he is essentially blacked out, and is left with no recall.

While under control, he has spread wilder versions of his story, and other things to undermine his own credibility, and sabotage his efforts to make the community aware of the dangers. He told the party his tale as himself, but the agent within is aware of everything that Fredu does, and knows the party is aware of the tale. Cyne needs four people to sacrifice to begin the spread of the aura, and the party, as annoying drifters will not be missed, especially if they have harmed or threatened local citizens.

With the information from Fredu fresh in their minds, the party now has a series of choices. The introduction encounter with Fredu and the Temple dungeon crawl are the bookends of the adventure, and the only encounters required to be completed to finish the adventure. However, finding the temple with so little information to go on will be risky.

The more logical plan is to follow up on some or all of the three leads directly provided by Fredu:

- Jopha drew a map that might be helpful to the party. He is a tavern owner in Boldon.
- Kreil, a sage living in Boldon, has a lambskin

parchment with some writing on it in a lost language. He said it contained a secret of the stronghold.

- Thamas, owner of the only pub in Pinto, drew another map that might be helpful to the party along with some sketches of the entrance.

The other three encounters are discovered by investigating and following up on leads:

- Fredu is the only non-cultist alive who knows where the room described in Kriel's translation is located. When the party sorts that they have no idea where the secret door is located, they will likely think to go back to Fredu to ask more questions. He will be in Maria, drunk, when the party catches up with him.
- While either investigating, or moving about Boldon (GM's discretion), the party encounters 4 cultists who are looking for either the party, or just some trouble (depending on which option the GM elects to use. The party is 25-35 feet from the cultists, and 15-20 feet from one of the main streets of Boldon when the cultists confront them. The party can move to end the encounter with a normal round of movement.
- There are a number of healers and mid-wives, and any of them can sell the party the materials necessary to restock their healing kits. However, the only healing potions to be bought in the region come from Saraq, an herbalist who lives in Sumer. The party will likely need to ask about where they can get healing supplies in Boldon and discover they must travel to Sumer to buy potions. There is an issue there for them to solve.

What Happens Next

If no one actively opposes Cyne and his cult, the following will happen:

- One more monthly sacrifice of an individual. The moon is waning, and the region will experience their next new moon two nights after the party hears Fredu's tale. On the new moon, there will be another sacrifice. The cult will abduct the victim for this sacrifice the night that the party meets with Fredu, and hold them in the temple, chained at the feet of Hastur. Every day after this upcoming new moon sacrifice, another will occur. The cult will begin abducting several people at a time (whole families), but with a twist.

- The crystals that the cultist plan to use to amplify the aura will all be installed in the temple in four days, and the cult will be ready to begin to amplify the dread aura of the Statue of Hastur. The next sacrifice calls for four victims. The cultist will sacrifice all of their victims at once, and Hastur's aura of dread will start to grow. The large sacrifice kicks off the channeling through the crystals
- The aura of dread will expand with high tide, but never contract with low tide, be maintained by a nightly sacrifice and be amplified with a quadruple sacrifice, called a feeding sacrifice, at each phase of the moon. After the initial sacrifice and three feeding sacrifices, the aura will expand to cover a circular radius of four miles centered on the temple entrance. This covers the entire town of Boldon. From this point forward the plan calls for 44 sacrifices per lunar month, which are the amount of souls required to grow the aura. One sacrifice per phase will maintain the aura once they are no longer expanding the aura.

- After twelve feeding sacrifices, (3 New Moons after the channeling sacrifice), the Aura will cover the entire Boldon region. The initial phase of the plan will be complete, and the cult will start taking over the region by corrupting and enslaving the leadership. They will recruit new members, and grow to a following strong enough to start expanding toward Lagdud. In a year, the Duchy of Lagdud will be under a similar assault, but with the statue placed under Lagdud Keep so the Duke is easier to influence, and corrupt. With the strategic placement of the statue, Lagdud Keep and the Duke will be under cult control four or five months after the statue begins to emit its aura. Conquering Lagdud will be a bloodless revolution, if you are willing to exclude the individuals sacrificed to each statue on each phase of the moon. Maintaining the aura requires four people to be sacrificed per statue per month.

If the players oppose them, and fail, the timeline will be impacted. If the party is victorious, then the temple will likely be destroyed.



Boldon Encounters

4 Cultists Enter an Alley (Combat Focused Encounter)

Actors: 4 Cult Fanatics

Motivation: Stop the players or beat them up in celebration of the coming horrors

Potential outcomes:

- Run away
- Defeat the Cultists
- Defeated by the Cultists

Description

This encounter works best when the party has been investigating and asking questions for a while. However, it can be played at any time. Most of the encounters in this phase of the adventure are designed to be completely optional, and can be skipped by ignoring the lead or by walking away. This encounter comes looking for the party. This encounter cannot be skipped per se but the party

can retreat easily. The details of the encounter will vary some depending on if there is any reason for this band of four cultist to be looking for the party. In that case, then the attackers make it clear that the party should stop asking questions, and intend to teach the party that they mean business. If not, this will be more of a chance encounter of overconfident cultists drunk on power who are looking for someone to victimize.

While in Boldon, the party enters an alley, and comes face to face with four human men in heavy cloaks who, after a brief verbal exchange, attack the party. The alley is 10 feet wide, about 30 feet long, and clear enough to be considered empty for combat purposes; however, a busy Boldon street is only 20 feet away. The party can run from the encounter easily. The two sides see each other as they enter the alley from opposite sides, starting the encounter at least 25 feet apart. Empowered by their ancient practice of linking, but away from the temple, the cultists attacks are at +2 for all their efforts (+2 to hit, or their spell DC/player saving throws are 2 points more difficult depending on the specific situation).



Cultists Attack In The Alley

Follow-up:

When two or more of the cultists go down, the remaining cultists surrender. The party finds 4 sets of cultist regalia and some minor treasure (~300 gold pieces in gems). The cultist will brag about their power and upcoming subjugation of the region as they resist interrogation and plot for an opportunity to escape. From the conversation and the combat, give the party an opportunity to learn the following:

- The cult is growing rapidly. They are adding 2 members a month. Hastur loves the number 40, so they paused recruiting for a short while once they hit 40 members, before starting a push bring in a member a week and get to 80 members.
- The cult is practicing an evil that has not been seen in over a millennium. This evil is strange enough that modern protections are not as effective as they are against modern magic. This is part of their bonuses in combat. A discovered practice of "Linking" (which is using their reaction to aid another cultist) allows them to attack at +2 when working together.
- They are emboldened by the seething evil in their temple, which equates to an advantage on all attacks when within 500 ft. of the statue of Hastur.
- They expect to extend the range of the statue's effect to encompass Boldon by amplifying the effect with large crystals that they have sourced, are taking delivery and installing near the statue.

The party may need to commission additional regalia, or otherwise fashion similar clothing if they intend to disguise more than 4 members of the party as cultists. They can find someone to do the work in Boldon, but can they be trusted? Are they the original maker of the regalia? (This one is for the GM to explore or skip)

Monster Stats: 4 Cultist Fanatics (See Bestiary)
1800 XP total
Cultist Fanatic (4): Human **SZ** M; **MV** 30'; **AC** 5; **THACO** 16; **ATK** 1d6x2; **HD** 2; **HP** 24; **INT** Average; **AL** LE; **LV** 2; **XP** 225 SA/AD *See Bestiary*

Jopha and his Temple Map

(Combat or Roleplay Focused Encounter, Non-combat XP 500/PC)

Actors: Jopha, 4 Priestesses, 4 Town Guard

Motivation: Jopha wants to ensure he gets a

reward for his map. If he is attacked, his children recruit some compatriots and ambush the party with the intent to punish them for harming their father.

Potential Outcomes

- Negotiate for the map (600gp, or equivalent)
- Attack the man
 - ◊ Be defeated by the ambush
 - ◊ Defeat the ambush
 - Successfully negotiate with Captain of Watch
 - Unsuccessfully negotiate with Captain of Watch

Description:

From Fredu's tale, the party may seek out Jopha. He is a fletcher and bowyer, in Boldon. His home is a few blocks from his shop. During the day, he normally can be found in or near his shop; he makes his way from home to the shop between breakfast and lunch. (Use any shop map you may have for his shop.) At night he makes his way home about 8 pm after dinner and a couple of pints at the Knave and Mug, slipping out before the night gives way to drunken revelry. Jopha is a shrewd businessman, and tries to see the angle in any offer. If the party follows up with him about what Fredu told him, he admits he heard the story, and took notes. When asked if he made a map, he is evasive at first, but information about him asking Fredu to verify accuracy in trade for extra ale will wear him down. He is not inclined to share the map. He is planning on organizing his own expedition of locals to go into the temple and loot any treasures they may find. This makes the idea of the party exploring the temple before him unattractive.

Follow-up:

The party might be able to convince him to share the map:

- Convince him that they will not (or cannot) carry off all the treasure
- Convince him to give them the map for a share of the treasure
- Convince him to sell the map
- Use intimidation, force or threat of force.

If the party uses force to get the map, Jopha is a trivial conquest; however, his family will come after the party and attack them. His family includes



Qrquito Finy, Captain of the Watch for Boldon

his son, a sergeant of the town guard, and his two daughters, both priests, and some of their friends. The attack will occur at a location of the DM's choosing; some place where they will have tactical advantage. Depends on what tactical maps you have and want to use.

There will be some form of consequences for entering combat with town guards, even in self-defense. The local command will see the bruises, the bodies, signs of a struggle, or the guards will cry foul to the local command. The players can probably RP their way out of an investigation if they can prove they were attacked by the guards; however, since this attack is provoked by attacking an elder citizen, it shouldn't be trivial to RP the issue away. This investigation will be easy to explain away if it follows the encounter with the corrupt local command in Pinto, since the Captain of the Watch will have an easy time believing that these people went rogue attempting to vindicate Vyncis, and might even be in collusion with him.

The Watch Captain, Qrquito Finy, lives in Boldon,

and sees to all conflicts that are referred to him by the Lieutenants of the 8 communities. His job has become more procedural than commanding until recently. He is a retired paladin. The LT's in each community are in command of the guards. He is in his early 30's, average height, bold with black, close cropped hair on the back of his scalp while the top has given way to baldness, grey eyes, clean shaven, with a strong build. While he does not directly command the guards in any of the villages, and manages largely ceremonial and investigative roles, he is not a slouch, and is a very capable combatant, in formation, with a party or in a duel.

Monster Stats: 4 Town Guard, 4 Town Priests
(*See Bestiary*) 2600 XP

Town Guard (4): Human **SZ M**; **MV** 30'; **AC** 3; **THACO** 18; **ATK** 1d6x2; **HD** 1; **HP** 12; **INT** Average; **AL** LN; **LV** 1; **XP** 100 SA/AD *See Bestiary*
Town Priest (4): Human **SZ M**; **MV** 30'; **AC** 4; **THACO** 17; **ATK** 1d6; **HD** 2; **HP** 24; **INT** Average; **AL** LN; **LV** 2; **XP** 225 SA/AD *See Bestiary*

Kriell the Sage and his translation

(**Role Play Focused Encounter, Non-Combat XP 500/PC**)

Actors: Kreil a sage and high level wizard

Motivation: Kreil craves knowledge. The books, scrolls and papers in the Temple interests him; not gold.

Potential Outcomes:

- Kreil is enticed to supply the information
- Kreil is attacked
 - ◊ The party is defeated
 - ◊ The party is victorious

Description:

Kreil is a sage who lives in Boldon. He finds the courts of Lagdud and Meawold far too loud, distracting and useless. Moving to Boldon has magnified his productivity many fold, even with the delays of having information transported from Lagdud and Meawold to Boldon using existing trade caravan schedules. Kreil is secretive, even a touch paranoid.

The room where Kreil receives visitors is small, and a bit spartan. His home is much different. Accessing the home from the reception room requires specific knowledge to open the door. If Kreil is attacked, the room could be their tomb.

He traded a few casks of ale and wine to Fredu for a lambskin parchment that had some writing



Kreil, Sage and retired battlemage

on it. The parchment is in a nearly lost language from the First Age of Man: a coded language used by the spreading cult of evil that nearly toppled the kingdoms of the First Age of Man.

Naturally, used to keep their communications from prying eyes. Kreil needed over a dozen books and scrolls and the better part of a season to translate. The parchment contains the directions for opening a secret door, not some real knowledge. However, he is wise and realizes the party values the parchment, and will extract a good price for it from the party. There are a number of things the party can offer Kreil in trade for the parchment translation:

- A significant amount of gold/ share of the treasure (2000 gp or a full share)
- All documents, scrolls and books found in the temple would go to Kreil exclusively

Follow-up:

To help increase their desire and raise their offering, he will reveal to them that the door these instructions open leads to the temple treasure room, and is the shortest path in the temple to the main altar. The operating of the secret door is quite complicated. To figure out the door's operation might take a lifetime. There are a total of 400 controls, each with 2 positions. Leaving 1.1 trillion possible combinations. (Think of the map room in Raiders of the Lost Ark, but with 4x as many holes in the floor)

Brute force against Kreil is not suggested. He was a power wizard before retiring to the courts of Meawold.

Combat with Kriel

If the party uses force against Kriel, they will discover they have poked the bear. Kriel's home is protected with a permanent wards:

- Kriel can cast any spell and the effects will be confined to the room or blast out the windows and exterior door
- With a gesture cloudkill can fill the room
- With a gesture the room falls under darkness
- In the room, casters other than Kriel take a 2

Managing Available Healing

In your campaign, you control the healing available to your players. This is normally done via adjusting the availability of potions, potion making supplies, hiring healers, town healers (including resurrection services)

This is a challenging adventure, and you might need to adjust your typical healing availability accordingly. How you do so is up to you. The Sumer encounter is one place that you can make adjustments. The number of potions available, and the number of potions Saraq might give the party for their help might not be the same quantity. Adjust as you see fit. The only right answer here is the one that is right for your game.

penalty to attack rolls and spell DC's

- Kriel resists bludgeoning, piercing and slashing damage

Kriel is exempt from the effects and Finy knows the password to make himself exempt.

Monster Stats: Kriel (Level 10 Wizard) (3900 XP)
Kriel: Human SZ M; MV 30'; AC 5; THACO 14;
ATK 1d8; HD 9; HP 72; INT Average; AL LE; LV 9; XP 1900 SA/AD *See Bestiary*

Village Encounters

Looking for Fredu – Maria

(Roleplay Focused Encounter, Non-Combat XP 600/PC)

Actors: Fredu, potentially 18 drunken men

Motivation: Fredu doesn't want to recall the details, they might bring back the nightmares. He will discuss the memories if motivated by the players.

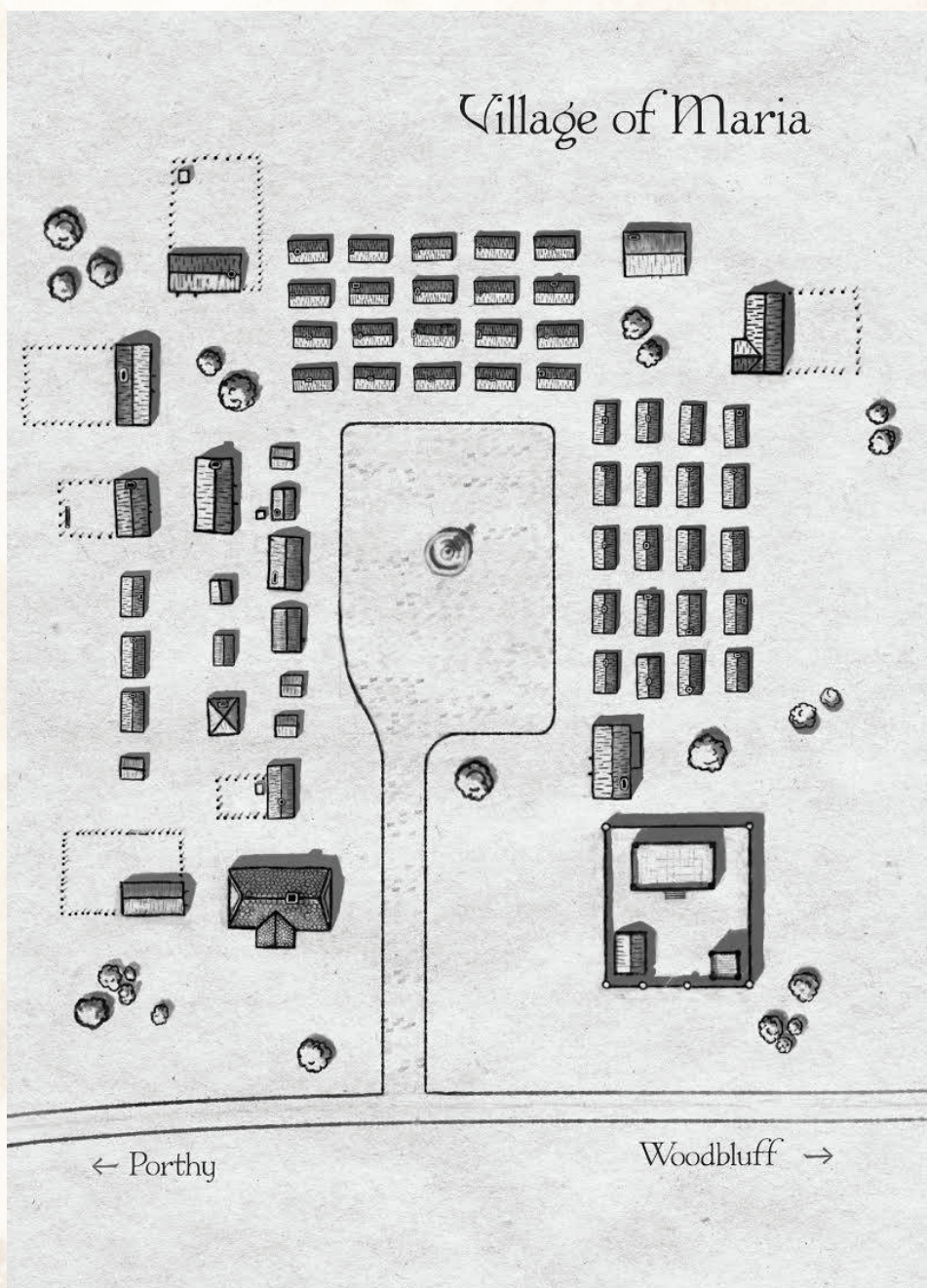

Potential Outcomes:

- Fredu supplies the information without force
- Fredu is attacked and his fellow drunks come to his aid
 - ◊ The party is defeated
 - ◊ The party is victorious

Description:

As the party investigates, they figure out that they have the instructions to open a secret door in the temple, but have no idea as to its location. Fredu is the only non-cultist alive who knows the location of this elaborate secret door. As he told Jopha and Thamas his story, Jopha didn't make note of where the parchment was found, or which room contained the elaborate floor to ceiling carvings that moved. Unfortunately, Kreil's translation does not include the location of the door either. The party may conclude they need to find Fredu and ask him about the location of the room.

This door leads to the room where the cult stores treasure they acquired from the ruins, and their efforts to take over the region through regular ritual sacrifices. The room is the short path to the statue room. The statue is the key to the advantage that the cultist have in battle against the players. Destroying or desecrating it will end their advantage, and make conquering the temple an easier task.

Fredu hasn't talked about the temple in detail for almost two years. He is reluctant to do so. Satisfied with drinking himself to death slowly, and forgetting the temple. The temple has a consistent, and terrifying dressing. Knowing which room hides the secret door will be a huge help, but it is not the kind of door that can be operated easily. The mechanism is so complicated that without the directions, the door might take a lifetime of research to open.

Follow-up:

Fredu has moved to Maria to try to work a couple of odd jobs to maintain his drinking without resorting to begging. He is living in a small room attached to the main tavern in Maria, The Unicorn's Alehouse. He is normally found sober working in the tavern cleaning up, and washing mugs. When he is in his room, he is drunk or blacked out. At work he isn't exactly sober, but he is coherent. The most likely place for the party to talk with Fredu is in The Unicorn's Alehouse. Use any tavern or inn map that works for you, if you require one.

Offering Fredu some coin to maintain his drunkard lifestyle, curing him of his alcoholism and what is essentially PTSD, reasoning with Fredu are all ways to coax him to reveal the location. If the party starts the 30 days of Lesser Restoration, Fredu will feel better immediately, but it will take finishing the full 30 day treatment for the cure to be permanent.

Fredu has been inside the temple since the party last met him, and has seen this door first hand. The agent's control of Fredu wavered a bit when they entered the aura for the first time and the agent basked in it. During this time, the agent portion of Fredu failed to keep him completely in the dark until he pressed the first tile. Fredu's reaction to the tile moving snapped the agent back into the moment, and he resumed full control of Fredu. Those memories of the reception room are all that remain from the event.

The bartender, Jennavieve, is tall, and powerfully built with jade eyes and long curly hair. She keeps to herself until the party gets rough with Fredu, then she will call down the thunder.

If the party resorts to force or violence to coax the location out of Fredu, sixteen other drunks join the fray, and the party finds themselves facing a mob of drunks. The drunks are a great opportunity to inject some humor into an otherwise serious and dark adventure. Feel free to use the optional abilities listed in the stat block to add some levity.

Monster Stats: 16 Town Drunks (*see Bestiary*) (3600 XP)

Town Drunk (16): Human **SZ** M; **MV** 30'; **AC** 8; **THACO** 18; **ATK** 1d6x2; **HD** 1; **HP** 12; **INT** Average; **AL** LN; **LV** 1; **XP** 100 SA/AD *See Bestiary*

Pinto and the Map

(Combat Focused Encounter)

Actor: Thamas, Vyncis, 4 Town Guards

Motivation: Thamas wants to live and not be extorted by Vyncis. Vyncis wants to maintain his power base, and accumulate wealth.

Potential Outcomes:

- Vyncis defeats the party
- Vyncis is defeated

Description:

At some point, the party may travel to Pinto to see if they can learn what Thamas knows about the location of the temple. From Fredu's tale, Thamas, the bartender at The Jester's Hall, was present when he exchange a detailed telling of his tale of



Vyncis, Captain of the Pinto Guard

the temple in trade for a large amount of ale, beer, and other alcohol. Since stumbling into that cave, Fredu has been firmly in the drinking cycle: passed out, hung-over, drinking, drunk. He traded his story for more booze after exhausting his savings, and selling everything he had of value.

When the party finds Thamas, he is no longer in possession of the map to the temple that he drew while Fredu told him and Jopha about the horrors he saw in the temple. He refused to pay protection to the leader of Pinto, and was visited by his enforcers who bashed his home to splinters then took everything of value. Thamas can be convinced to tell the party how he came to lose the map pretty easily. It is in the possession of the local captain of the guard.

The captain of the Pinto guard, Vyncis, has a total of four guards in his office and antechamber. (Level 4 fighters) Two of them flank him in his office, the other two are in the outer room. In addition, he

is a proficient soldier as well. If a fight breaks out, the two in the outer room will join during round two, on their own initiative(s). The party could bribe Vyncis for the map, and avoid bloodshed, but his price is high. Say 1500 gp. (Which should be painfully expensive to the party, if not, adjust the amount until it is expensive.) Vyncis would take some convincing to lower the price or give the map to the party without significant compensation. (Set the DC high enough to require an 18-20 on the die to meet it.)

The outer office is small, about 10' by 20' and furnished with a small table with a pair of chairs for the guards and 6 more chairs for people waiting to see the leader. The inner office is twice as large, 20' by 20' with a nice desk, a nice chair for the leader, four chairs in two ranks of two facing the leader for those wishing to meet with him, and two chairs behind the leader where the guards sit. The guards stand next to their chairs whenever someone is in the office with Vyncis. They are vigilant whenever there are visitors in the room. Perhaps a reaction to the significant ill will Vyncis has generated with his corruption and organized protection racket since being posted here. The Boldon Captain of the Watch, if shown evidence of Vyncis's protection racket and other corruption, will not consider attacking Vyncis a crime.

Use any building tactical map that works for you, don't forget to adjust the room description accordingly if you do so. There will likely be no consequences for attacking this local garrison. Vyncis is corrupt and unobvious; the villagers will come to the defense of the players if the DM has an investigation reach the party. This may have a positive influence if this event precedes a violent encounter with Jopha's children in Boldon. However, if that encounter goes poorly and precedes this one, there will be an uphill struggle to convince the Watch Captain that this was another bout of self-defense against a rogue or corrupt element of the local watch.

Monster Stats: Vyncis, 4 Town Guard (*See Bestiary*) (2600XP)

Vyncis: Human SZ M; MV 30'; AC 3; THACO 16; ATK 2d10x2; HD 7; HP 100; INT Average; AL LN; LV 8; XP 900 SA/AD *See Bestiary*
 Town Guard (4): Human SZ M; MV 30'; AC 8; THACO 18; ATK 1d6x2; HD 1; HP 12; INT Average; AL LN; LV 1; XP 100 SA/AD *See Bestiary*



Attack on an old man outside Sumer

Sumer and the Herbalist

(Neutral Encounter, Non-Combat XP 500/PC)

Actors: Saraq, his 13 year old daughter - Helia, twelve longshoremen from Sumer

Motivation: Saraq and his daughter want to survive, and help people. The longshoremen are transferring their grief into an attack on old man.

Potential Outcomes:

- If the party aids the men in the attack on the old man, and he lives, they will have a long road ahead of them to convince him to sell even one potion to them, and if he does, at a markup.
- If the party kills the old man, then they have effectively painted themselves into a bit of a corner. The daughter, Tanfleue, is not yet skilled enough to brew a healing potion.
- Potions can be sourced from Lagduf, with a 5-7 day turn around, a total supply of 10, and a 3x markup due to the transportation expenses.
- The party might be able to hire a level 3 cleric from the local clergy (DM's discretion), but will need to be seen more hero than thug locally, and provide some financial support for the church.
- If the party uses force, they will find their welcome in Sumer icy, but no one will directly confront the party over the assault as long as no one is killed.
- If any of the men are killed, the Captain of the Watch in Boldon, Finy will be called to intervene, and the party will need to talk or buy their way out of being charged with a crime. Sumer will be hostile to the players, but no violence will occur. Saraq will be blamed for the death(s) and will eventually move to Woodbluff. (Using violence as your default tool has consequences)

Description:

The party tries to restock their supplies in Boldon, and are unable to find any healing potions. All of the villages have people proficient in the healing arts; however, only Sumer has someone who can brew healing potions. After asking around in Boldon, they are advised to seek Saraq in Sumer. Saraq moved to Sumer about a year before. Many people can tell the party he moved to Sumer in hopes the salt air might help his daughter breath more easily.

At some point the party may travel to Sumer, a large fishing village on the coast that is about 11 miles northwest of Boldon. Within a mile of the village, they encounter an old man and his young daughter (about age 11) being harangued and assaulted by twelve men with what appear to be quarter staves. The men chant "murderer" at the old man as they strike him about the back, legs

and head with their staves. As he tries to run away, he is tripped with a staff roughly shoved between his ankles, and the round robin assault begins anew. The party knows they are headed to see an herbalist in Sumer, and that he is an old man with a young daughter who moved from Boldon to Sumer. Could this be the man they seek? Is it just an old man who is being drummed out of town for a crime?

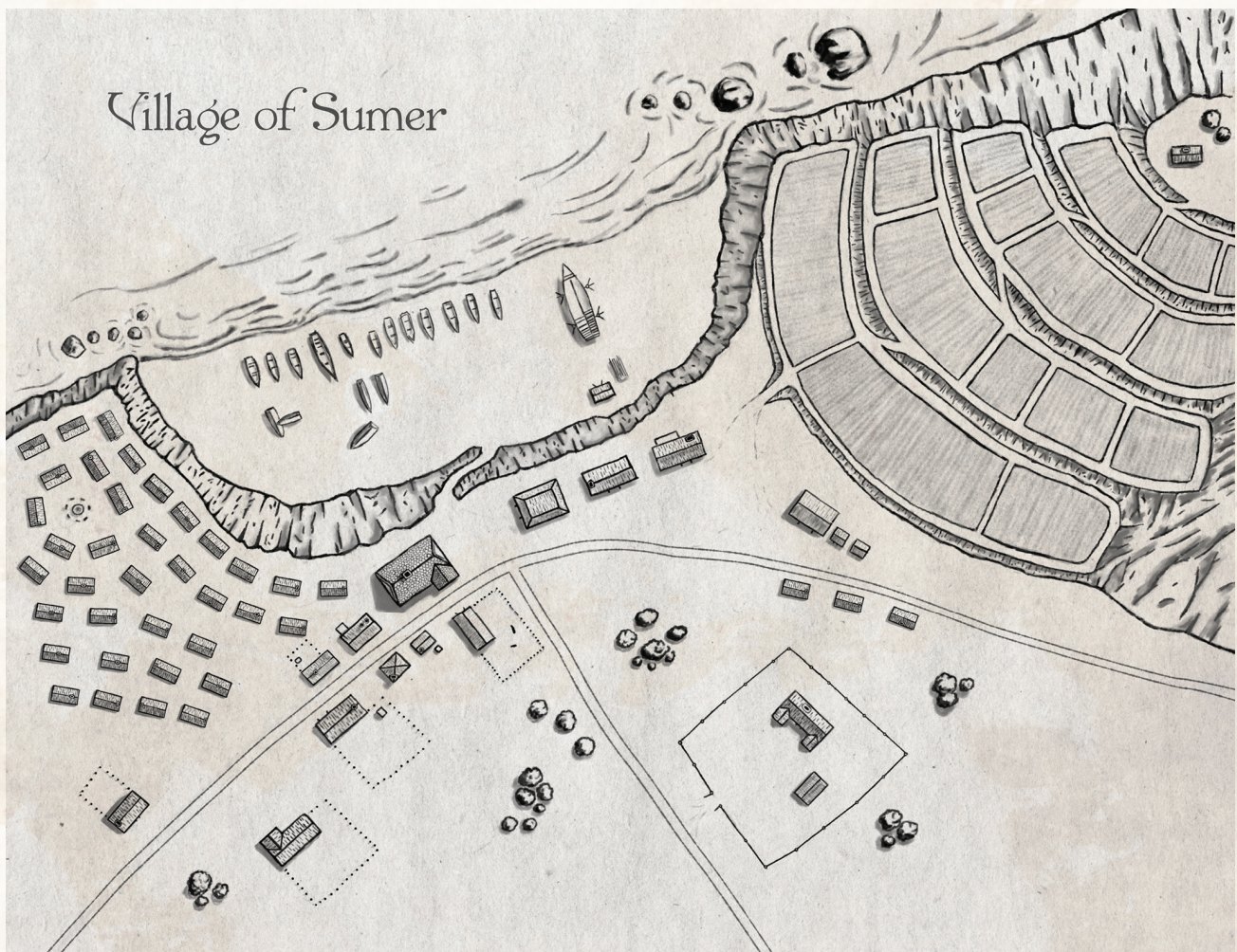



Seaside Fishing Village, Sumer

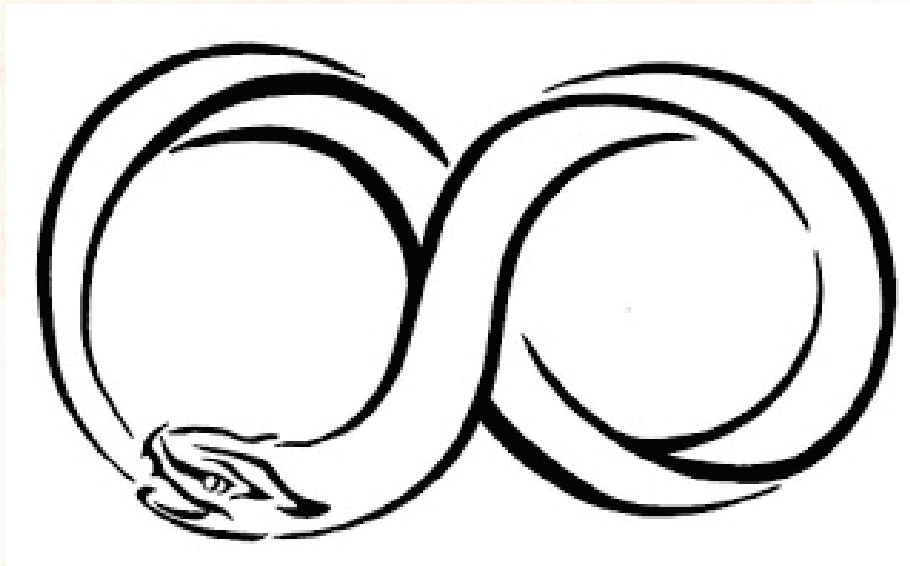

Hastur's Symbol, Infinite Snake

Follow-up:

The old man is the herbalist potion brewer and the men are attacking him for unjust reasons, but this will not be immediately apparent to the players. One of the attackers lost his wife recently after a cure from the herbalist was given. Turns out the cure was delivered too late and the man's wife was too far gone to survive. Blame being better to give than receive, the husband's friends convinced him the herbalist is a fraud, and not because they waited over two weeks to seek treatment for her illness. If the party aids the old man, by word or deed, he will reward them with his entire supply of healing potions (4-9 of them depending on what is appropriate for your game, and the party's current supply levels, or d6+3).

Should things get out of hand, the Captain of the Watch, Qrquito Finy, becomes involved, defense of innocent life is acceptable. Killing twelve men will require some silver tongued justification, or a suitable stack of coin.

The twelve men, a mixture of longshoremen types and fishermen, with their crude staves have a poor chance to hit the old man, hitting only on an 18+; however; the old man has 15 health remaining, and his daughter has 6 health total (currently she is unharmed). Both the old man and the young girl have AC 10, and cannot make any attacks or effectively defend themselves.

The area where the encounter occurs is near a crossroads between the path from Boldon to Sumer and the path from another fishing village and one of the farming villages. There are some trees and rocks within range of the crossroads to be effective. Use any crossroads map you desire for this encounter.

Monster Stats: 12 Town Guard (Do not use minimum damage of 1, treat a roll of 1 as no damage.) (1200 XP)

Town Guard, Modified (12): Human **SZ M**; **MV** 30'; **AC** 8; **THACO** 20; **ATK** d4-2 (see above); **HD** 0; **HP** 6; **INT** Average; **AL** LN; **LV** 1; **XP** 50
SA/AD: do not use minimum damage of 1, treat a roll of 1 as no damage.

Finding the Temple

There are a few ways that the party can find the temple of Hastur, and confront the growing threat to the peaceful farms and fishermen of the Boldon region. The temple was initially discovered by Fredu, and his tale led to a map being drawn that leads to the location. Since Fredu's discovery of the lost temple, Cyne has been seduced by Hastur to reawaken the cult. Cyne has brought the rosters to forty members, so there is enough foot traffic for the party to find the entrance if they do not have a map. The entrance is in the rocky region between Boldon and Pinto, marked on the region map with Church Icon. A line of rock about 2 miles long (10,000 feet), running along a line that separated Maria from Pinto when the earthquake happened with about 40 feet of displacement. This left a lot of the farmland near the upheaval unusable.

Pinto Mission

The temple location is indicated on the region map. The region is the scene of most of the upheaval from the earthquake. Following that map will lead the party within line of sight of the rough cave entrance that Fredu followed to the original entrance of the lost temple. The terrain is rough, and halves movement rates and potentially exposes the party to wandering monsters checks once they leave the roads.

Clues and a wilderness search

The information supplied by Fredu is enough for anyone with tracking abilities to find the temple entrance itself or signs of the cultist patrols, which will lead to the temple entrance. The temple is indicated on the region map. Finding the entrance will take quite a while. Potentially exposing the party to wandering monsters checks. (1 on a d6)

Regional Random Encounter Table (3 per hour)

1. Bandit Captain (MM 344, cr 2) and 15 x Bandit (MM 343, cr 1/8); 825 xp
2. 4 x Will-o-wisp (MM 301, cr 2); 1800 xp
3. 2 x Cult Fanatics (See Bestiary, cr2); 900xp
4. 3 x Giant Elk (MM 325, cr 2); 1350 xp
5. 3 x Cult Fanatics (See Bestiary, cr2); 1350 xp
6. 4 x Swarm of Poisonous Snakes (MM 338, cr 2); 1800 xp
7. Orog (MM 247, cr 2) and 7 x Orc (MM 246, cr 1/2); 1150 xp
8. 4 x Giant Elk (MM 325, cr 2); 1800 xp

The Temple Delve

Dungeon History:

The dungeon was created by Dwarven craftsmen as commissioned job over two thousand years ago. It was taken over and dressed for worship of Hastur about 1500 years ago, sealed by wizards over a millennium ago, exposed by an earthquake and partially restored by new followers of the cult over the last few years.

Dungeon Walls: Superior Masonry (DC 20 to climb). The walls have been engraved with geometric patterns as crown molding and baseboard decorations. Ceilings are typically ten feet high. Most walls are covered in floor to ceiling heavy woolen theatre curtains. (They absorb almost all noise, and resist fire, save versus fire DC 6 due to an enchantment)

Dungeon Floor: Flagstone

Temperature: Slightly cooler than typical room temperate, but not so cold as to affect the party.

Air: a breeze pulses in and out of the temple in synchronization with the surf coming in and out along the coast. This air comes through passages too small for anyone to travel.

Illumination: Well lit by magic every at regular intervals. All rooms are well lit unless otherwise noted. Player actions might alter this.

Random Encounters: There are at the start, 40 occupants of the temple grounds. All but 5 of them are in the encounter areas. The remainder are running errands and might be encountered when using the **Regional Random Encounter Table**.

Additionally, groups move within the temple regularly. If a random encounter is called for, pick a group from an encounter area and have the party encounter them while moving through the temple. Examples of this could include:

- The party has a random encounter in area 10, they encounter a group from Area 13 headed to the Kitchen (Area 8) for wine (or the opposite they are returning with wine)
- The party has a random encounter in area 5, they encounter the group from Area 11 getting back from patrol and checking in with the head priest, Cyne.

Any group can be potentially encountered randomly if the situation calls for it.

Room 1 - Reception Room

This room is 15' x 25'. The walls are covered in floor to ceiling heavy curtains, maroon with simple contrasting stitching of yellow. Behind the curtains, the walls are covered in deeply engraved elaborate geometric patterns in 1'x1' grids. On the north wall, the center of each square foot pattern has a 2 inch square section that can be pressed about 2 inches inward. The wall has five panels each with fifty squares. The middle panel is a secret door, and the center sections do not respond when pressed inward. The remaining panels are the operating mechanism to a secret door. A specific combination of pressed sections opens the door. There are many trillion combinations. To try them all would take several lifetimes. No critical success or luck will help. Without knowing which panels to press, the secret door will not open. Otherwise the room is clean, non-descript with no other significant features. No cultist has figured out that there is a secret to this puzzle.

No one is in this room.

Room 2 - Hub Room

This is a hub room, 15'x15', of the main temple. It connects the various parts of the temple to each other; including prayer rooms/cells, kitchen, dining area, preparation room and the other parts of the temple such as the entrance and the Reception

Managing the 5 Minute Adventuring Day

If the players take too many rests have the action come to them. Give each rest a 50% chance of being disrupted by a cultist attack. The attacks might just enough to disrupt the Long Rest. Use a die to determine which hour of the rest the attack comes, with a 1 representing the 4th hour of the rest. I.E, the party takes an 8 hour rest, the attack will occur on hour d4+3. This will ensure the rest is ruined for recovery purposes, and hopefully inspire the party to keep moving forward.

Another option is to have each rest advance the cultist's plot a step, or have another citizen abducted or killed. See the section "What happens next" for more details.

rooms. It is adorned like the bulk of the temple with floor to ceiling deep maroon woolen curtains that have a bold yellow contrast stitching. There is a low table below a mural that holds a collection of cult artifacts. The mural depicts the old god Hastur devouring the soul of a victim, casting his lifeless husk aside. The artifacts are small fetishes of Hastur, a copy of their prayer book, some ritual daggers (dull because they are symbolic, no actual sacrificial tools, some small stone cubes that might be dice without pips, and a bowl full of runes for casting.

There is no one in this room.

Room 3 – Cultist Quarters

This room, 15'x20', is a prayer room and residence for 4 cultists. It contains 4 bedrolls, 4 prayer rugs, an incense burner, several bundles of incense, and a book of prayer. The walls are covered in floor to ceiling heavy curtains, maroon with simple contrasting stitching of yellow. The room, like all prayer rooms is a bit Spartan. If they are sleeping or praying, the weapons, armor and other effects of the cultists are in a bundle at the side of each sleeping or praying cultist. If they are awake, and not in prayer, the bedrolls are rolled neatly with the other effects stacked next to the roll while the cultists rest, study, exercise or prepare for patrol.

What are the cultists doing (d20)

- 1-5 Out on Patrol
- 6-12 Sleeping (surprised)
- 13-17 They are praying (surprised)
- 18-20 They are lounging about the room (surprised)

Due to the curtains, and their focus, it is likely the cultists will be surprised, then attack.

Monster Stats: 4 Cult Enforcer (2800 XP)
Cult Enforcer (4): Human **SZ M**; **MV** 30'; **AC** 3; **THACO** 16; **ATK** 2d6 x2; **HD** 4; **HP** 48; **INT** Average; **AL** LE; **LV** 4; **XP** 350 SA/AD *See Bestiary*

Special note Locations 4&5

If encountered at night, the cook and assistant will be encountered in Location 5 – Kitchen, and caught by surprise; either busy working or asleep. During the day, the cook and his assistant are active, cleaning the dining room (Location 4) when not in the kitchen (Location 5) preparing meals, cleaning or otherwise tending to the needs of the

kitchen. They will normally be taken by surprise. The table below can be consulted to determine what these 2 people are doing and where they are located. (D12)

- 1-4 Sleeping (Location 5)
- 5-9 Working in Kitchen (Location 5)
- 10-11 Cleaning the dining area (Location 4)
- 12 The entire temple staff is dining (Location

The party hears the din, adequate warning.

Monster Stats: 1 Enforcer of the Old God, 1 Cult Soldier (2700 XP)

Enforcer of the Old God (1): Demon **SZ M**; **MV** 30'; **AC** 5; **THACO** 15; **ATK** 4d6; **HD** 8; **HP** 72; **INT** Average; **AL** CE; **LV** 2; **XP** 1000 SA/AD *See Bestiary*

Cult Soldier (1): Human **SZ M**; **MV** 30'; **AC** 3; **THACO** 14; **ATK** 1d8x2, 1d6; **HD** 5; **HP** 40; **INT** Average; **AL** LE; **LV** 2; **XP** 350 SA/AD *See Bestiary*

Room 4 - Dining Hall

This room, 40'x30', is the dining hall for the temple. All meals for the cultists while working on the temple grounds are taken here. Along the south wall is a bench that runs the length of the wall. Four 8'x4' tables are placed end to end aligned with the south wall, a foot or so from the bench. On the east and west walls, in the corners formed with the south wall are benches designed to seat two people. On the north wall straddling the doorway in the north wall are stacks of 2 benches, each designed to seat 4 people. The built-in bench seats 20 people. The combined tables seat 16 people per long side and 2 on each end. The cultists take their mid day meal together as one body.

See Special note for Temple Locations 4 and 5 for information about who may be in this room.

Room 5 - Kitchen

This room, 20'x15', is the kitchen area. This is not a typical kitchen. The cultists are fed via "Summon Food and Water" spells, and served wine. This room stores tableware, serving ware, wine glasses and casks of wine. Additionally there are 3 tables for summoning and plating the meals. Additionally the cook and his assistant bed here when not working.

See Special note for Temple Locations 4 and 5 for information about who may be in this room.

Room 6 – Cultist Quarters

This room, 25'x20', is a prayer room and residence for 4 cultists. It contains 4 bedrolls, 4 prayer rugs, an incense burner, several bundles of incense, and a book of prayer. The walls are covered in floor to ceiling heavy curtains, maroon with simple contrasting stitching of yellow. The room, like all prayer rooms is a bit Spartan. If they are sleeping or praying, the weapons, armor and other effects of the cultists are in a bundle at the side of each sleeping or praying cultist. If they are awake, and not in prayer, the bedrolls are rolled neatly with the other effects stacked next to the roll while the cultists rest, study, exercise or prepare for patrol.

What are the cultists doing (d20)

- 1-5 Out on Patrol
- 6-12 Sleeping (surprised)
- 13-17 They are praying (surprised)
- 18-20 They are lounging about the room (surprised)

This is a room with 6 cultists preparing to patrol the temple. They will not be surprised, and will attack the party on sight.

Monster Stats: 4 Cult Fanatics (2700 XP)
Cult Fanatic (4): Human **SZ** M; **MV** 30'; **AC** 5; **THACO** 16; **ATK** 1d6x2; **HD** 2; **HP** 24; **INT** Average; **AL** LE; **LV** 2; **XP** 225 SA/AD *See Bestiary*

Room 7 – Cultist Quarters

This room, 25'x20', is a prayer room and residence for 6 cultists. It contains 6 bedrolls, 6 prayer rugs, an incense burner, several bundles of incense, and a book of prayer. The walls are covered in floor to ceiling heavy curtains, maroon with simple contrasting stitching of yellow. The room, like all prayer rooms is a bit Spartan. The bedrolls are rolled neatly with the other effects stacked next to the roll while the cultists are on patrol.

There is no one in this room.

Room 8 – Cultist Quarters

This room, 15'x20', is a prayer room and residence for 4 cultists. It contains 4 bedrolls, 4 prayer rugs, an incense burner, several bundles of incense, and a book of prayer. The walls are covered in floor to ceiling heavy curtains, maroon with simple contrasting stitching of yellow. The room, like all prayer rooms is a bit Spartan. If they are sleeping

or praying, the weapons, armor and other effects of the cultists are in a bundle at the side of each sleeping or praying cultist. If they are awake, and not in prayer, the bedrolls are rolled neatly with the other effects stacked next to the roll while the cultists rest, study, exercise or prepare for patrol.

What are the cultists doing (d20)

- 1-5 Out on Patrol
- 6-12 Sleeping (surprised)
- 13-17 They are praying (surprised)
- 18-20 They are lounging about the room (surprised)

Most likely, the cultists will be surprised, then will attack. Otherwise they are on patrol.

Monster Stats: 4 Cult Enforcer (2800 XP)
Cult Enforcer (4): Human **SZ** M; **MV** 30'; **AC** 3; **THACO** 16; **ATK** 2d6 x2; **HD** 4; **HP** 48; **INT** Average; **AL** LE; **LV** 4; **XP** 350 SA/AD *See Bestiary*

Room 9 – Training Room

This room, 30'x30', is used by the cultist to maintain their martial and casting skills. It has some targeting dummies along the west wall, and some mats to soften falls taken while practicing combat skills in the middle of the floor. There are some training weapons on a rack long the south wall. They are of little to no value, inflict no lethal damage, and in combat will break after 2-4 hits

The 5 monks in this room train all of the cultists to be stronger, faster and more lethal. They will rarely be surprised (1 on a d10 if rolling, or something crafty if RP'ing). They will attack the party as soon as they see an enemy of the cult.

If using tactical combat style rules, all but the outer most 5 feet of the room is covered in pads which doubles movement costs as if it were difficult terrain. The monks sleep in this room.

Monster Stats: 5 Cult Monk (2250 XP)
Cult Monk (5): Human **SZ** M; **MV** 30'; **AC** 2; **THACO** 14; **ATK** 1d8x2; **HD** 2; **HP** 24; **INT** Average; **AL** LN; **LV** 2; **XP** 225 SA/AD *See Bestiary*

Room 10 – Cultist Quarters

This room, 25'x20', is a prayer room and residence for 4 cultists. It contains 4 bedrolls, 4 prayer rugs, an incense burner, several bundles of incense, and a book of prayer. The walls are covered in floor

to ceiling heavy curtains, maroon with simple contrasting stitching of yellow. The room, like all prayer rooms is a bit Spartan. If they are sleeping or praying, the weapons, armor and other effects of the cultists are in a bundle at the side of each sleeping or praying cultist. If they are awake, and not in prayer, the bedrolls are rolled neatly with the other effects stacked next to the roll while the cultists rest, study, exercise or prepare for patrol. Rancent is the second in command in the temple. He is Cyne's Lieutenant, and the most dangerous melee combatant.

What are the cultists doing (d6)

- 1-2 Sleeping (surprised)
- 3-4 Praying (surprised)
- 5-6 Lounging about the room (not surprised)

Monster Stats: 2 Cult Soldiers, Rancent (3900 XP)
Cult Soldier (2): Human SZ M; MV 30'; AC 3; THACO 14; ATK 1d8x2, 1d6; HD 5; HP 40; INT Average; AL LE; LV 2; XP 350 SA/AD See *Bestiary*

Rancent: Human SZ M; MV 30'; AC 2; THACO



Cyne, Priest of Hastur

13; ATK 1d10+6x2; HD 71; HP 90; INT Above Average; AL LE; LV 7; XP 900 SA/AD See *Bestiary*

Room 11 – Ritual Room

This room, 20'x25' is used to store the mundane items of the cult's victims and the dusty husks left behind from the sacrifice. It contains personal items from all of the victims. The husks crumble to dust within a few days. The room is thick with dust.

Room 12 – Ritual Room

This room, 20'x25' is used for some kind of ritual outside the main temple. There is a large runic circle on the floor. A DC 25 Religion check will reveal that the circle is used to test the cultist to ensure they are pure.

For OSR, any caster will recognize this as a runic circle and that stepping within will trigger something. Those with a deep knowledge of religion will recognize it as something designed to harm those aligned with good, and to a lesser degree those who are neutral in their leanings. Only an expert in ancient religions would be able to directly discern that this is a testing circle, but the party may deduct that from more general knowledge.

Other than the runic circle drawn in chalk on the floor, the floor to ceiling maroon woolen curtains with the yellow contrast stitching and the magic light sources, there are no other furnishings in the room.

There is no one in the room.

Room 13 - Preparation Room

This room, 20'x25', is the preparation room where cultists transition from the general temple grounds to the altar room. Cultists purify themselves with 3 basins of clear, foul smelling liquid, and 2 braziers of incense smoke before donning their temple robes and entering the temple. In the room are 2 large jugs of each of the clear liquids, and one large bundle each of the herbal and heady incense is stored in the south west corner under a maroon sheet. One basin each of the 3 clear liquids sitting on a table along the East wall. One brazier of herbal incense and one brazier of a heavy, heady incense frame the table on the East wall. Along the north wall are 50 temple robes.

Cultists sweep the heady smoke of the south most incense burner before dipping their arms to their elbows in the three liquids before sweeping the herbal incense smoke over themselves,

donning their robes and entering the altar room. While the alcohol might produce a cooling or stinging sensation depending on the state of the skin where it is applied, the water will result in almost no sensation, and the hydrogen peroxide might bubble a bit, the chemicals are actually harmless. The party should not be told what the chemicals are, and discovery should be entertaining. There is no one in this room.

Room 14 - Altar Room

"At the farther end was a high stone dais reached by five steps; and there on a golden throne sat a lumpish figure robed in yellow silk figured with red and having a yellow silken mask over its face." - H.P. Lovecraft, The Dream-Quest Of Unknown Kadath

This room is 50' x 60', the ceiling is 20' high and has over a dozen crystals about the size of a human foot embedded as well as another two dozen holes for more crystals (40 in total). It is the main altar room. During ceremonies, the priest goes to a pedestal in the treasury to get the Book of Hastur and displays it on a stand near the altar. The passage from the chapel to the treasury is not hidden by curtains, merely framed by them. In the middle of the north wall rests a very large statue of Hastur sitting on a throne. At his feet 2 rings are set into the base with stapes, presumably to secure sacrifices. The statue of Hastur rises 12' on a stone dais 5 steps above the floor. It weighs nearly a ton, and radiates a sickeningly evil aura. Before Hastur is an altar. It is about 3' high, made of a pale green stone and clearly has been used for a large number of humanoid sacrifices.

The statue is emitting an aura of evil that the players can sense. Lawful or good aligned players will take efforts to avoid the statue. (If in combat, double movement costs to move closer to the statue) Lawful Good players will really struggle to get close unless their intent is immediate destruction.

The Book of Hastur has pages of lambskin, gold furniture and is covered in demon skin. (Think Necronomicon, only flashier.) While it is worth 3000gp, most good parties will likely opt to destroy it. Kreil would consider this a significant find, and would pay 1000gp for it, if such information is not part of a deal for the translation of the lambskin parchment.

The floor is covered in large geometric shapes, etched into the stone. There are no furnishings. In

the middle of the south wall is a passage to the head priest's quarters (Area 15). This passage is obscured by the floor to ceiling sound dampening curtains that line most of the rooms in the temple.

When not in use (which amounts to 22 hours a day), the room has three cultists (well they look like cultists, 2 of them are enslaved demons who appear like human cultists) who are tending to the room, cleaning it, and preparing the ceiling for more crystals. For an hour centered on sunrise and sundown, the temple is full of cultists: 40 of them. Attacking then would be suicide. However, if the party insists, let them die failed heroes.

Toppling the statue will destroy it, and end the aura of evil that empowers the cultists. (If toppled in combat, have the effect end at the start of the next combat round) While the statue is intact, all cultists have an edge on all efforts against the party. (PC saves when attacked by cultists are with disadvantage, or cultist attack rolls have advantage). When the statue is destroyed, the cultists lose advantage, and reverts to the +2 to all attacks and Save DC's (Linking - See Appendix). It is possible for two people of average strength to put their back against the wall behind the statue, and push the statue over. One might be able to do it if they push off from the wall nearer the head, but that would require a DEX save DC 15 (OSR: roll below their dex on a d20) to avoid taking 2d10 damage. Only in combat should a strength check be required to topple the statue of Hastur. Out of combat, it is merely a matter of teamwork or exertion to accomplish.

Monster Stats: 2 Agents of the Old God, 1 Cult Soldier (2900 XP)

Agent of the Old God (2): Demon **SZ** M; **MV** 30'; **AC** 4; **THACO** 15; **ATK** 1d8 x2; **HD** 6; **HP** 60; **INT** Average; **AL** NE; **LV** 6; **XP** 550 SA/SD **See Bestiary**

Cult Soldier (1): Human **SZ** M; **MV** 30'; **AC** 3; **THACO** 14; **ATK** 1d8x2, 1d6; **HD** 5; **HP** 40; **INT** Average; **AL** LE; **LV** 2; **XP** 350 SA/AD **See Bestiary**

Room 15 - Cyne's Chambers

This room small room, 15'x15' off the altar room is the quarters of the head priest of the Cult, Cyne. Both ends of the 10' passage between the altar room and Cyne's private chambers are closed off with heavy, woolen floor to ceiling curtains. The chamber is not lavishly appointed, but it is comfortable. The room has a desk, a bed, a pair of storage trunks, a tall shelf holding books and scrolls and a small table for mixing and concocting

poisons. He is a true believer and feels that posh quarters are a sign of corruption.

He will not hear any fighting in the chapel unless it gets between the two sets of curtains that separate his room from the altar room or a spell/effect causes the curtains to be disturbed enough for him to hear. He will smile when first encountered, but if the party does not submit, will attack immediately. If the party submits, and agrees to join the cult, he will hold an initiation that will require a DC 20 Constitution check (OSR: System Shock Roll) to survive. If the party joins the cult, the adventure is effectively over, and the players become NPC's. There is no treasure in this room. All of it is in the treasury.

Monster Stats: Cyne (3800XP)
Cyne: Human **SZ** M; **MV** 30'; **AC** 5; **THACO** 12;
ATK 1d6x2; **HD** 9; **HP** 72; **INT** High; **AL** LE; **LV** 10; **XP** 1900 SA/AD *See Bestiary*

Room 16 - Treasure Room

This room is quite large 30' x 40'. It is the treasury. The walls are bare and between the crown molding and baseboard geometric engravings, they are adorned with 5 lovely murals. Small murals frame the doors in the east wall, and larger murals adorn the North, South and West walls. All 5 tapestries depict they heyday of the cult when they conquered various kingdoms in their quest to rule the world of men. The room contains:

- 600 cp, 10000 sp, 2600 gp, 60 pp
- Ornate Silver Mirror set with Hematite (250 gp)
- Ivory Necklace set with Moonstone (250 gp)
- Silver Miniature (of a Tree) set with Citrine (250 gp)
- Platinum Cloth Vest (250 gp)
- Tooled Leather Bracers (250 gp)
- Sable Gloves (250 gp)
- Spell Scroll (Thunderous Smite)
- 4x Potion of Greater Healing, Potion of Climbing
- A pedestal holding the Book of Hastur.

Resolution

Conquering the temple, destroying the temple and killing the majority of the cultists will break the cult. The remainder of cultists, if any, will be tracked down and killed. The party will likely want to reseal the temple. This can be done in a number of ways.

- They can use magic (Arcane or Divine) and collapse the tunnel, remove the defiled energy and allow

nature to reclaim the area.

- The party can pay laborers to fill in the tunnel with boulders and other large rocks, fill in the gaps with gravel and mark off the area as forbidden. This method will take longer due to the dark energies that permeated the land.
- The party can come up with some crazy idea to collapse the tunnels by some other way.

Let them have some fun with this stage of the adventure. If the party is not comfortable re-sealing the temple themselves, Lagduf or Meawold will send Wizards and Clerics to seal the temple for the good of the kingdom. The area will be shunned for a generation (3 if not purified first) then once again forgotten.

The mayor of Boldon, Tane, will weigh the party's intent, any harm they caused to the community and any statement they would like to make before deciding their fate within the region. Count Gylip of Meawold will declare the party heroes and reward them accordingly. However, the mayor of Boldon is more sensitive to assaults on town guards, etc. and may feel the party are more villains than heroes. Gylip will pardon any sentence that Tane might hand down. However, the party will no longer be welcome in the Boldon region if their mayor is overruled by Count Gylip. In addition to the rights to keep the contents of the cult treasury, he rewards the players with 1500gp each (adjusted to fit your campaign economy). If the party elects to try to come to some kind of middle ground with Boldon, Duke Bertio has shown all sides he is a wise man who balances all concerns deftly.

Reaction to the Party

The cultists will likely not hear the party due to the heavy curtains, and the wheezing nature of what functions as their ventilation system.

If a cultist is able to run away and alert the others, no cultist will be surprised and they will all be ready for an attack; however, since they are expecting at most the town guard, and not a party of adventurers, they do not actively hunt down intruders. Their arrogance could be their undoing.

If one or more of the cultists who attack the party in the alley escape, then the reaction to the party will be much different. Add patrols of 4-5 enforcers regularly throughout the temple (encountered on a roll of 1 on a d6 when entering any empty room or corridor. However, if the cultist defeat the party during the attack in the alley, they assume they are not a threat to the temple.

Bestiary

Agent of the Old God

(Challenge 4 - 1,100 XP)

Demon **SZ M**; **MV** 30'; **AC** 4; **THACO** 15; **ATK** 1d8 x2; **HD** 6; **HP** 60; **INT** Average; **AL** NE; **LV** 6; **XP** 550 **SA**: Soul Drink - if both claw attacks hit, take 2d8 damage, save vs. spells for half damage

5e Stats

- Medium fiend, NE; AC 16; HP 86; Spd 30 ft; DEX 17 (+3); CHA 20 (+5)
- Skills: Deception +9, Insight +5, Perception +5, Persuasion +9, Stealth +7, darkvision 60 ft
- **Damage Resistance**: Bludgeoning, piercing, and slashing from non-magical weapons, Cold, Fire
- **Shapechanger** - The fiend can use its action to polymorph into any S/M creature
- **Claw (Fiend Form)** - Melee Attack: +5 to hit, Hit: 8 (1d8 + 3) slashing damage.
- **Multiattack** - the fiend makes 2 Claw Attacks on the same target
- **Soul Drink** - If the fiend hits with both claws during a Multiattack, the fiend drinks from their soul. 16 (2d10 + 5) psychic, DC 15 Con save for half damage. Max HP reduced by damage total until target finishes a long rest.

Cult Enforcer

(Challenge 3 - 700 XP)

Human **SZ M**; **MV** 30'; **AC** 3; **THACO** 16; **ATK** 2d6 x2; **HD** 4; **HP** 28; **INT** Average; **AL** LE; **LV** 4; **XP** 350

5e Stats

- Human, LE; AC: 17; HP 40; Spd 30 ft.;
- STR 15 (+2); DEX 14 (+2); Saving Throws +3
- **Multiattack** - makes two greatsword attacks.
- **Greatsword** - Melee Attack: +4 to hit, reach 5 ft.; Hit: 11 (2d6 + 4) slashing damage

Cult Fanatic

Challenge 2 (450 XP)

Human **SZ M**; **MV** 30'; **AC** 5; **THACO** 16; **ATK** 1d6x2; **HD** 2; **HP** 24; **INT** Average; **AL** LE; **LV** 2; **XP** 225 **SA**: spells command, inflict light wounds x2, shief of faith, hold person x2, spiritual weapon

5e Stats

- Human; Cleric 4; LE; AC 15; HP 38; + 6; Spd 30 ft.
- DEX 15 (+2); Skills Deception +4, Persuasion +4, Religion +2, Perception +0

- **Fanatic Frenzy** - The fanatic has advantage on saving throws vs. being charmed or frightened.
- **Spells**: Spellcasting DC 17
- 1st level (4 slots): command, inflict wounds
- 2nd level (3 slots): hold person, spiritual weapon
- **Multiattack** - The fanatic makes two melee attacks.
- **Dagger** - Melee or Ranged Weapon Attack: +4 to hit, reach 5 ft. or range 20/60 ft., Hit: 4 (1d4 + 2) piercing

Cult Monk

Challenge 2 (450 XP)

Human **SZ M**; **MV** 30'; **AC** 2; **THACO** 14; **ATK** 1d8x2; **HD** 2; **HP** 24; **INT** Average; **AL** LN; **LV** 2; **XP** 225

5e Stats

- Human, Monk 4; LN; AC 18; HP 40; Spd 30 ft.;
- DEX 18 (+4); WIS 18 (+4); Saving Throws Str +4, Dex +6, Int +3, Wis +4
- **Psychic Defense** - While wearing no armor AC includes its Wisdom modifier.
- **Multiattack** - makes two unarmed strikes.
- **Unarmed Strike** - Melee Attack: +6 to hit; Hit: 7 (1d8 + 2) bludgeoning damage plus 5 (2d4) psychic damage. This is considered a magic weapon attack.

Cult Soldier

Challenge 3 (700 XP)

Human **SZ M**; **MV** 30'; **AC** 3; **THACO** 14; **ATK** 1d8x2, 1d6 or 1d8; **HD** 5; **HP** 40; **INT** Average; **AL** LE; **LV** 2; **XP** 350

5e Stats

- Human, Fighter 5; LE; AC 17; HP 48; Spd 30 ft.;
- STR 16 (+3); Skills Athletics +5, Perception +2
- **Multiattack** - The veteran makes two longsword attacks, and a shortsword attack.
- **Longsword** - Melee Attack: +6 to hit, Hit: 8 (1d8 + 3) slashing or 9 (1d10 + 3) slashing
- **Shortsword** - Melee Attack: +6 to hit, Hit: 7 (1d6 + 3) piercing damage.
- **Heavy Crossbow** - Ranged Attack: +3 to hit, range 100/400 ft., Hit: 6 (1d10) piercing damage.

Cyne

CR 8 (3,900 XP)

Human **SZ M**; **MV** 30'; **AC** 5; **THACO** 12; **ATK** 1d6x2; **HD** 9; **HP** 72; **INT** High; **AL** LE; **LV** 10 (Cleric 7, Assassin 3); **XP** 1900 **SA**: Inflict Serious Woundsx2, Inflict Light Woundsx4; Mace - Souls-masher +2, can cast blindness on each successful hit.

5e Stats

- Human, Cleric 5, Assassin 5; LE, AC 15 (studded leather); HP 128; Spd 30 ft.
- DEX: 20 (+5); CON: 14 (+2); Saving Throws Dex +9
- Skills: Acrobatics +7, Stealth +11; Resist Poison; Perception +4
- **Spells:** Spellcasting DC 18
- Cantrips: Sacred Flame;
- Level 1 (4 Slots): Inflict Wounds;
- Level 2 (4 Slots): Blindness/Darkness;
- Level 3 (2 Slots): Spirit Guardians
- (Prefers to cast Inflict Wounds at higher level vs others)
- **Evasion** - Per the Rogue Ability
- **Sneak Attack** (1/Turn). Per the Rogue Ability, extra 14 (4d6) of the same type damage as the weapon making the sneak attack
- **Multiattack** - The assassin makes two mace attacks and one dagger attack. Or casts a spell and makes an offhand attack with poisoned dagger
- **Dagger** - Melee Attack: +9 to hit; Hit 5 (1d4+3) piercing damage and taking 25 (7d6) poison damage, saving throw for half damage (DC15 Con).
- **Mace** - Melee Attack: +9 to hit; Hit: 7 (1d6 + 3) blunt damage, and taking 25 (7d6) poison damage, saving throw for half damage (DC 15 Con).
- **Magic Mace** - See Appendix.

Daughters of Jopha (Town Cleric)

(Level 5 Cleric)

Challenge 3 (550 XP)

Human SZ M; MV 30'; AC 4; THACO 17; ATK 1d6; HD 2; HP 24; INT Average; AL LN; LV 2; XP 225 SA/AD *See Bestiary*

5e Stats

- Medium human, LN; AC 16; HP 37; Spd 25 ft.; WIS 16 (+3);
- Skills Medicine +7, Persuasion +3, Religion +4
- **Divine Eminence** - Bonus action, expend spell slot, melee attacks deal an extra 3d6 radiant damage on hit.
- **Spells;** Spellcasting DC 15
- Cantrips: light, sacred flame, spare the dying
- 1st level (4 slots): cure wounds, inflict wounds, guiding bolt, bless
- 2nd level (3 slots): hold person, silence
- 3rd level (3 slots): dispel magic, spirit guardians
- Mace - Melee Attack: +4 to hit, Hit: 7 (1d6+3) bludgeoning damage.

Enforcer of the Old God

Challenge 6 (2,000 XP)

Demon SZ M; MV 30'; AC 5; THACO 15; ATK 4d6; HD 8; HP 72; INT Average; AL CE; LV 2; XP 1000 SA: save vs spells or half of damage taken also reduces max hp until rested for a week, or affected by spell like Greater Restoration

5e Stats

- Medium fiend, CE; AC 15; HP 84; Spd 30 ft.;
- STR 15 (+2), DEX 15 (+2); Saving Throws Dex +5, Wis +5; Skills Perception +5
- Damage Resistances: cold, fire, lightning; Damage Immunity: poison; Senses: darkvision 120 ft.
- Magic Resistance - advantage on saving throws against spells and magical effects.
- **Death Touch** - Melee Attack: +5 to hit; Hit: 9 (2d6 + 2) piercing damage plus 20 (5d6) necrotic damage.

Kreil (Level 10 Wizard)

Challenge 8 (3900XP)

Human SZ M; MV 30'; AC 5; THACO 14; ATK 1d8; HD 9; HP 72; INT Average; AL LE; LV 9; XP 1900 SA: Spells: Magic Missile, Sleep, Shield x2, blur, ray of enfeeblement x2, fireball, lightning bolt, vampiric touch, ice storm x2, evards black tentacles, cloudkill cone of cold; SD Reduces damage taken from melee and ranged weapons by half

5e Stats

- Human, LN; AC 15; HP 71; Spd 30 ft.; INT 20 (+5); WIS 18 (+4); CHA 18 (+4)
- Saving Throws Int +8, Wis +7, Cha +7; Skills: Arcana +8, Insight +7, Perception +7, Persuasion +7, Stealth +4
- **Resistance** - advantage on saving throws against spells and other magical effects. Resist physical damage
- **Staff** - Melee Attack: +7 to hit, reach 5 ft., one creature. Hit: 10 (1d10 + 4) damage.
- **Spellcasting** - Spellcasting DC 18; +8 Spell to hit
- Cantrips : fire bolt, ray of frost
- 1st level (4 slots): magic missile, shield, sleep
- 2nd level (3 slots): blur, invisibility, ray of enfeeblement, scorching ray
- 3rd level (3 slots): blink, fireball, lightning bolt, vampiric touch
- 4th level (3 slots): evard's black tentacles, ice storm,
- 5th level (2 slots) : cloudkill, cone of cold

Rancent (Cyne's Lieutenant)

Challenge 5 (1800XP)

Human SZ M; MV 30'; AC 2; THACO 13; ATK 1d8+6x2 and 1d6+4; HD 7; HP 75; INT Above Average; AL LE; LV 7; XP 900

5e Stats

- Human, Fighter 7; LE; AC 18; HP 90; Spd 30 ft., swim 50 ft.; STR 19 (+4); DEX 15 (+2); CON 16 (+3)
- **Saving Throws:** Dex +5, Con +6, Int +5, Wis +4; Skills Perception +7;
- **Blood Frenzy** - . Rancent has advantage on melee attack rolls against any creature that doesn't have all its hit points.
- **Multiattack** - Rancent makes two attacks with longsword and one attack with shortsword

- **Longsword** – Melee Attack: +7 to hit; Hit: 12 (1d10+6) slashing damage
- **Shortsword** - Melee Attack: +7 to hit; Hit: 10 (1d6 + 6) slashing damage

Town Drunk (Level 3 Rogue)

Challenge 1 (200 XP)

Human **SZ M**; **MV** 30'; **AC** 8; **THACO** 18; **ATK** 1d6x2; **HD** 1; **HP** 12; **INT** Average; **AL** LN; **LV** 1; **XP** 100 SA/AD *See Bestiary*

5e Stats

- Human, LN; AC 12; HP 32; Spd 25 ft; STR
- **Multiattack** - makes two melee attacks.
- **Improvised Weapon** - Melee Attack: +4 to hit, Hit: 5 (1d6 + 2) bludgeoning damage.
- **Improvised Weapon** - Ranged Attack: +4 to hit, range 10/30, 5 (1d6 + 2) slashing damage.
- **Staggering Dodge** – after missing an attack, anyone attacking the drunk does so with disadvantage until the start of the drunks next turn
- **Moment of Coordination** – when the drunk hits a player for more than half damage, another drunk in melee range can use their reaction to attempt to knock the player prone. The attack succeeds if the player fails a Dex save.

Town Guard

Challenge 1/4 (50 XP)

Human **SZ M**; **MV** 30'; **AC** 3; **THACO** 18; **ATK** 1d6x2; **HD** 1; **HP** 12; **INT** Average; **AL** LN; **LV** 1; **XP** 100

5e Stats

- Human, Fighter 3; LN; AC 17; HP 27; Spd 30 ft; Skills Perception +2
- **Spear** - Melee or Ranged Attack: +4 to hit, reach 5 ft. or range 20/60 ft., one target. Hit: 4 (1d6 + 4) piercing damage.

Vyncis

Challenge 5 (1800 XP)

Human **SZ M**; **MV** 30'; **AC** 3; **THACO** 16; **ATK** 2d10x2; **HD** 7; **HP** 100; **INT** Average; **AL** LN; **LV** 8; **XP** 900

5e Stats

- Human, Fighter 7; LN; AC: 17; HP 112; Spd 30 ft.
- STR 18 (+4); DEX 14 (+2); Saving Throws: Str +7, Dex +5, Con +6
- **Multiattack** - makes two greatsword attacks.
- **Greatsword** - Melee Attack: +4 to hit, reach 5 ft.; Hit: 14 (2d10 + 2) slashing damage plus 8 (2d6) bludgeoning

Appendix

Magic Items

Book of Hastur

This book has pages of lambskin, gold furniture and is covered in demon skin. It radiates evil. While of significant value to those who study religion, arcane knowledge or seek to protect the world from its evil, most good aligned players will feel more inclined to destroy it than to save it. It contains a number of evil rituals (the exact details are left to the GM) and a detailed history of Hastur and his plans to devour civilization and reform it in his own image. The book is a minor artifact. It is worth at least 3000gp to most collectors. Maybe more if the person has a special interest.

Soulsmasher

Hastur's temple held a treasure. A mace +2 that was imbued with his evil life force. This mace is black as night, reflecting almost no light. When it hits a target, the wielder can cast darkness on any target he can see. When the weapon scores a critical hit, the wielder is healed for an amount equal to the damage dealt on the attack. This weapon radiates evil. Any good or neutral character who grasps it, will suffer disadvantage on all attacks and actions until the item is no longer in contact with the character. If kept near the character for more than a day, the player will begin to suffer from exhaustion and will not be able to regain HP or Hit Dice during long rests. Each use of the healing the wielder on a critical hit consumes a charge. The mace has 40 charges and when exhausted, the mace can only be recharged with a blood sacrifice of someone vitally important to the wielder. Over the expediture of the last 4 charges, the wielder will come to know this requirement.

Special Effect - Linking

The effect of the Aspect of Hastur on the world allows the cultist some additional abilities when outside the aura.

5E

The cultists use their reaction to give an ally that they can see a +2 bonus to all attacks, spell DC's and saving throws

OSR

If any cultist is within 10 feet of another cultist, they are at +2 to attack, defense and have a 2 point bonus on saving throws and all party saving throws have a 2 point penalty.

OPEN GAME LICENSE Version 1.0a

The following text is the property of Wizards of the Coast, Inc. and is Copyright 2000 Wizards of the Coast, Inc ("Wizards"). All Rights Reserved.

1. Definitions: (a) "Contributors" means the copyright and/or trademark owners who have contributed Open Game Content; (b) "Derivative Material" means copyrighted material including derivative works and translations (including into other computer languages), potation, modification, correction, addition, extension, upgrade, improvement, compilation, abridgment or other form in which an existing work may be recast, transformed or adapted; (c) "Distribute" means to reproduce, license, rent, lease, sell, broadcast, publicly display, transmit or otherwise distribute; (d) "Open Game Content" means the game mechanic and includes the methods, procedures, processes and routines to the extent **such content does not embody the Product Identity and is an enhancement over the prior art and any additional content clearly identified as Open Game Content by the Contributor, and means any work covered by this License, including translations and derivative works under copyright law, but specifically excludes Product Identity. (e) "Product Identity" means product and product line names, logos and identifying marks including trade dress; artifacts, creatures, characters, stories, storylines, plots, thematic elements, dialogue, incidents, language, artwork, symbols, designs, depictions, likenesses, formats, poses, concepts, themes and graphic, photographic and other visual or audio representations; names and descriptions of characters, spells, enchantments, personalities, teams, personas, likenesses and special abilities; places, locations, environments, creatures, equipment, magical or supernatural abilities or effects, logos, symbols, or graphic designs; and any other trademark or registered trademark clearly identified as Product identity by the owner of the Product Identity, and which specifically excludes the Open Game Content; (f) "Trademark" means the logos, names, mark, sign, motto, designs that are used by a Contributor to identify itself or its products or the associated products contributed to the Open Game License by the Contributor (g) "Use", "Used" or "Using" means to use, Distribute, copy, edit, format, modify, translate and otherwise create Derivative Material of Open Game Content. (h) "You" or "Your" means the licensee in terms of this agreement.
2. The License: This License applies to any Open Game Content that contains a notice indicating that the Open Game Content may only be Used under and in terms of this License. You must affix such a notice to any Open Game Content that you Use. No terms may be added to or subtracted from this License except as described by the License itself. No other terms or conditions may be applied to any Open Game Content distributed using this License.
3. Offer and Acceptance: By Using the Open Game Content You indicate Your acceptance of the terms of this License.
4. Grant and Consideration: In consideration for agreeing to use this License, the Contributors grant You a perpetual, worldwide, royalty-free, non-exclusive license with the exact terms of this License to Use, the Open Game Content.
5. Representation of Authority to Contribute: If You are contributing original material as Open Game Content, You represent that Your Contributions are Your original creation and/or You have sufficient rights to grant the rights conveyed by this License.
6. Notice of License Copyright: You must update the

COPYRIGHT NOTICE portion of this License to include the exact text of the COPYRIGHT NOTICE of any Open Game Content You are copying, modifying or distributing, and You must add the title, the copyright date, and the copyright holder's name to the COPYRIGHT NOTICE of any original Open Game Content you Distribute.

7. Use of Product Identity: You agree not to Use any Product Identity, including as an indication as to compatibility, except as expressly licensed in another, independent Agreement with the owner of each element of that Product Identity. You agree not to indicate compatibility or co-adaptability with any Trademark or Registered Trademark in conjunction with a work containing Open Game Content except as expressly licensed in another, independent Agreement with the owner of such Trademark or Registered Trademark. The use of any Product Identity in Open Game Content does not constitute a challenge to the ownership of that Product Identity. The owner of any Product Identity used in Open Game Content shall retain all rights, title and interest in and to that Product Identity.
8. Identification: If you distribute Open Game Content You must clearly indicate which portions of the work that you are distributing are Open Game Content.
9. Updating the License: Wizards or its designated Agents may publish updated versions of this License. You may use any authorized version of this License to copy, modify and distribute any Open Game Content originally distributed under any version of this License.
10. Copy of this License: You MUST include a copy of this License with every copy of the Open Game Content You distribute.
11. Use of Contributor Credits: You may not market or advertise the Open Game Content using the name of any Contributor unless You have written permission from the Contributor to do so.
12. Inability to Comply: If it is impossible for You to comply with any of the terms of this License with respect to some or all of the Open Game Content due to statute, judicial order, or governmental regulation then You may not Use any Open Game Material so affected.
13. Termination: This License will terminate automatically if You fail to comply with all terms herein and fail to cure such breach within 30 days of becoming aware of the breach. All sublicenses shall survive the termination of this License.
14. Reformation: If any provision of this License is held to be unenforceable, such provision shall be reformed only to the extent necessary to make it enforceable.
15. COPYRIGHT NOTICE
Open Game License v 1.0a © 2000, Wizards of the Coast, Inc. System Reference Document 5.0 Copyright 2016, Wizards of the Coast, Inc.; Authors Mike Mearls, Jeremy Crawford, Chris Perkins, Rodney Thompson, Peter Lee, James Wyatt, Robert J. Schwalb, Bruce R. Cordell, Chris Sims, and Steve Townshend, based on original material by E. Gary Gygax and Dave Arneson.

END OF LICENSE

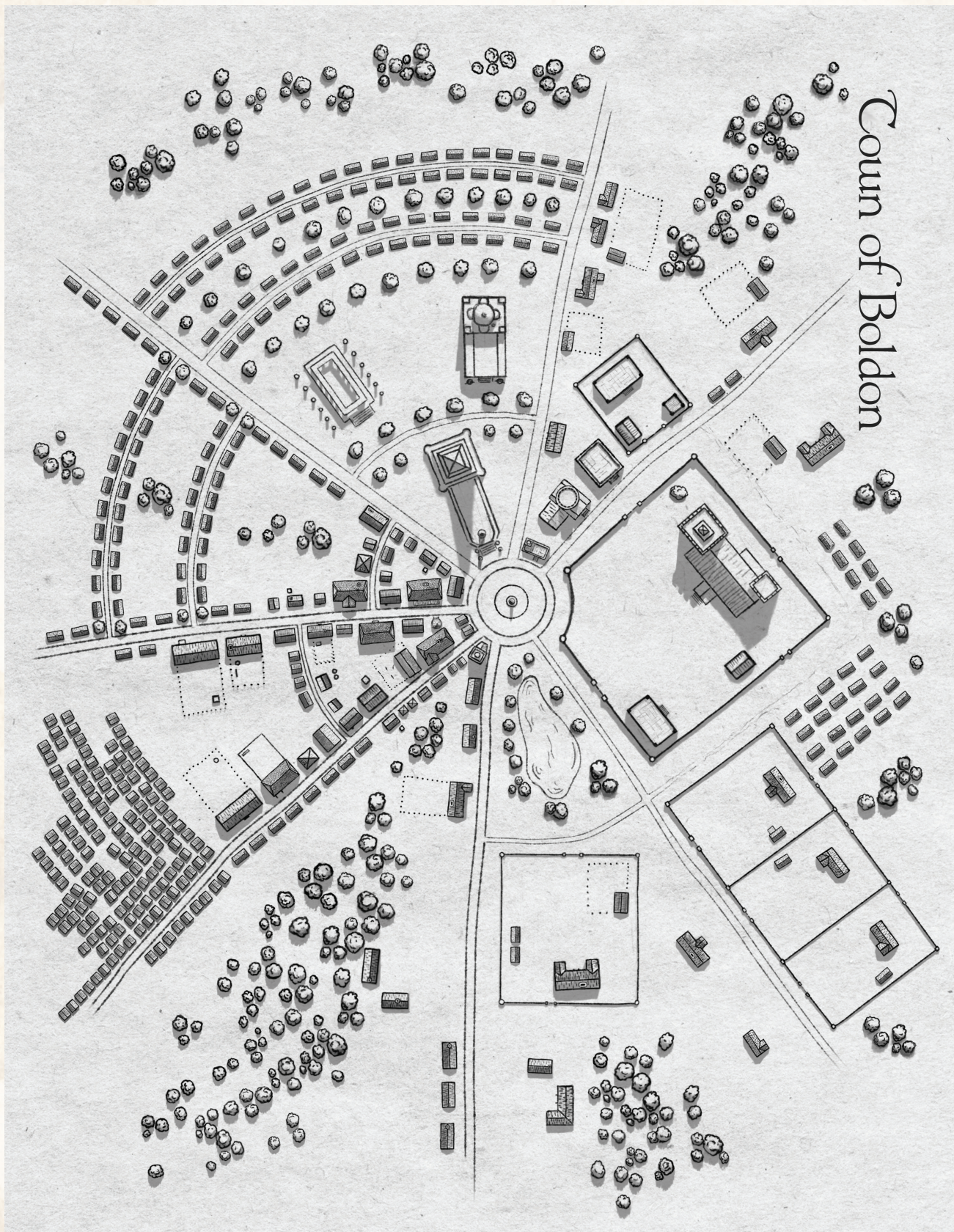

Town of Boldon

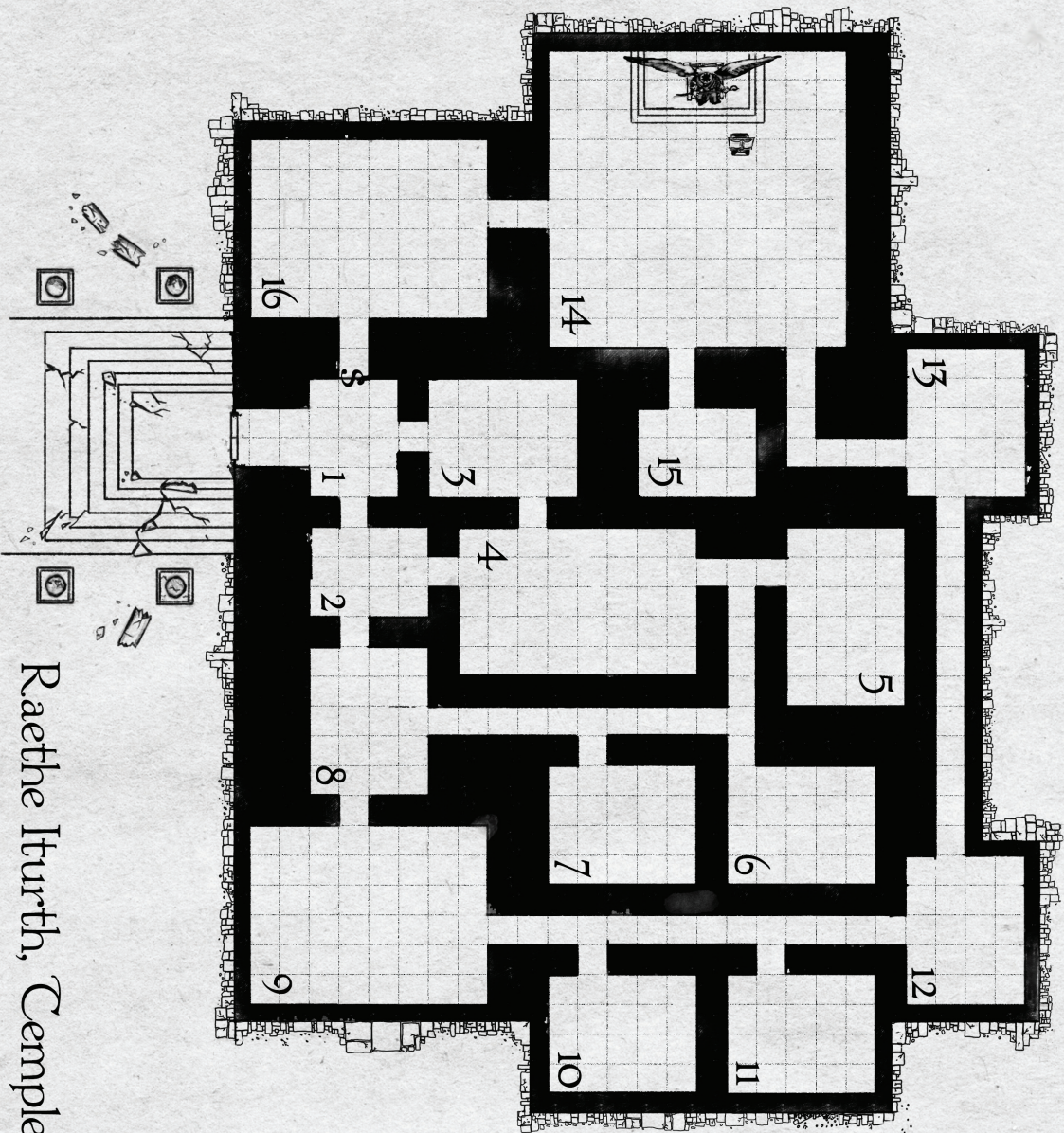

Raethe Iturth, Temple of Nastur



The small town of Boldon, and its surrounding villages are afraid. Dozens of people are missing, some speculate lost to some nefarious purpose. A broken drunkard tells fantastic tales of an evil temple and the horrible things within. The rare few who know the legends and history of the region are beginning to think the dark times have returned; not seen since the fall of the first age of man. People are beginning to feel the icy fingers of fear closing in. The party becomes aware of these events, and is inspired to investigate. This leads them to a broken man who tells them a story of a lost temple. Has it been rediscovered by men seduced by its forgotten evil? The drunkard's tale leads to others who might help the party discover more before they face *The Lost Temple of Forgotten Evil*.