

Castle of the Mad Archmage™



By Joseph Bloch

Illustration Book



HOW TO USE THIS BOOK

There are certain areas within the Castle of the Mad Archmage for which verbal description alone might be insufficient to convey the full tone, and for which an illustration is more likely to impart the “feel” of a place or object. Too, sometimes drawing attention to a particular detail in a verbal description might alert players to the fact that something is amiss, whereas burying such detail in an illustration can ensure that only alert players are rewarded.

Certain areas and encounters detailed in the Castle of the Mad Archmage Adventure Book will instruct the game master to show the players a numbered illustration. These numbers correspond to the numbered illustrations in this book. No more detailed label (either referring to the subject matter or even the location of the encounter within the dungeons) is given, lest it betray information to the players that they might not otherwise have.

For areas that are seen, show the appropriate illustration for as long as they care to view it, noting carefully how long they linger taking in the vista, and count such time as being spent in the dungeon itself. For objects such as maps, allow the players to refer to them at will, as long as they have the physical object with their characters. Otherwise they must rely on memory.

CREDITS

Design Joseph Bloch

ArtistsFil Kearney, Luigi Castellani, Maurine Starkey, Michael Vilardi

Text and design copyright © 2013 BRW Games, LLC all rights reserved.

Artwork is copyright of the respective artists, all rights reserved.

Castle of the Mad Archmage™ is a trademark of BRW Games, LLC.

Visit us at www.brwgames.com

No portion of this booklet is designated as Open Game Content under the Open Game License.

THIS IS NOT A COMPLETE ADVENTURE! YOU WILL NEED BOTH THE ADVENTURE BOOK AND THE MAP BOOK TO EXPLORE THE CASTLE OF THE MAD ARCHMAGE!

Castle of the Mad Archmage



Illustration 1

Castle of the Mad Archmage

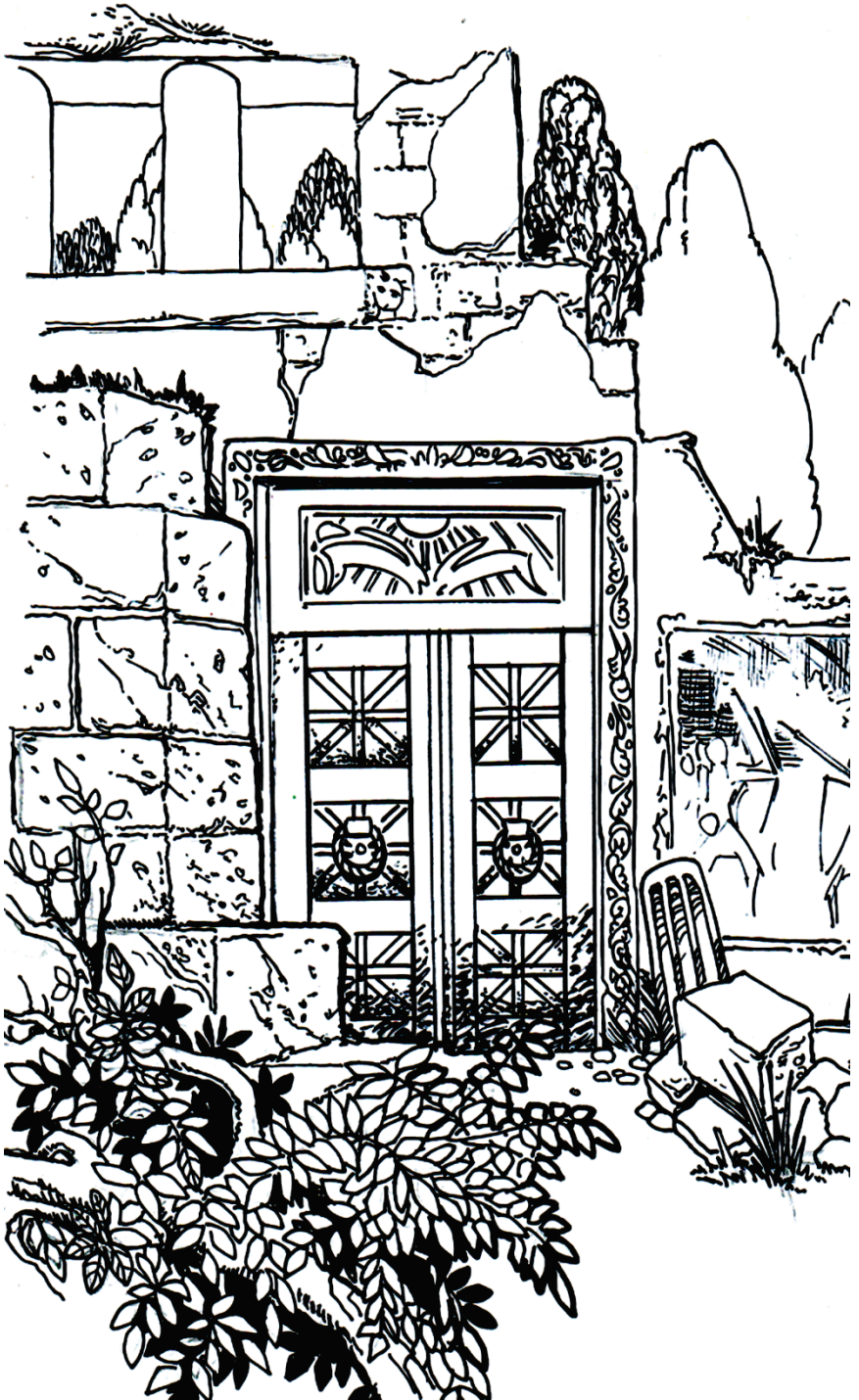

Illustration 2

Castle of the Mad Archmage



Illustration 3

Castle of the Mad Archmage

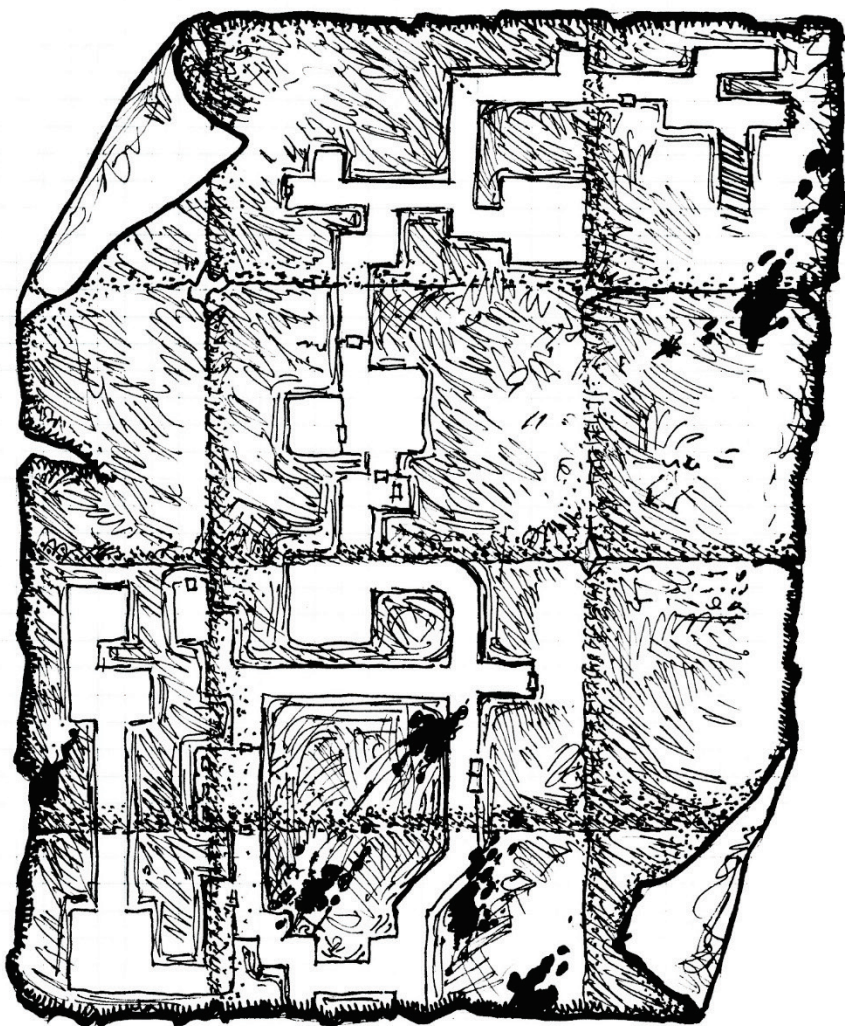

Illustration 4

Castle of the Mad Archmage



FilKearney'13

Illustration 5

Castle of the Mad Archmage

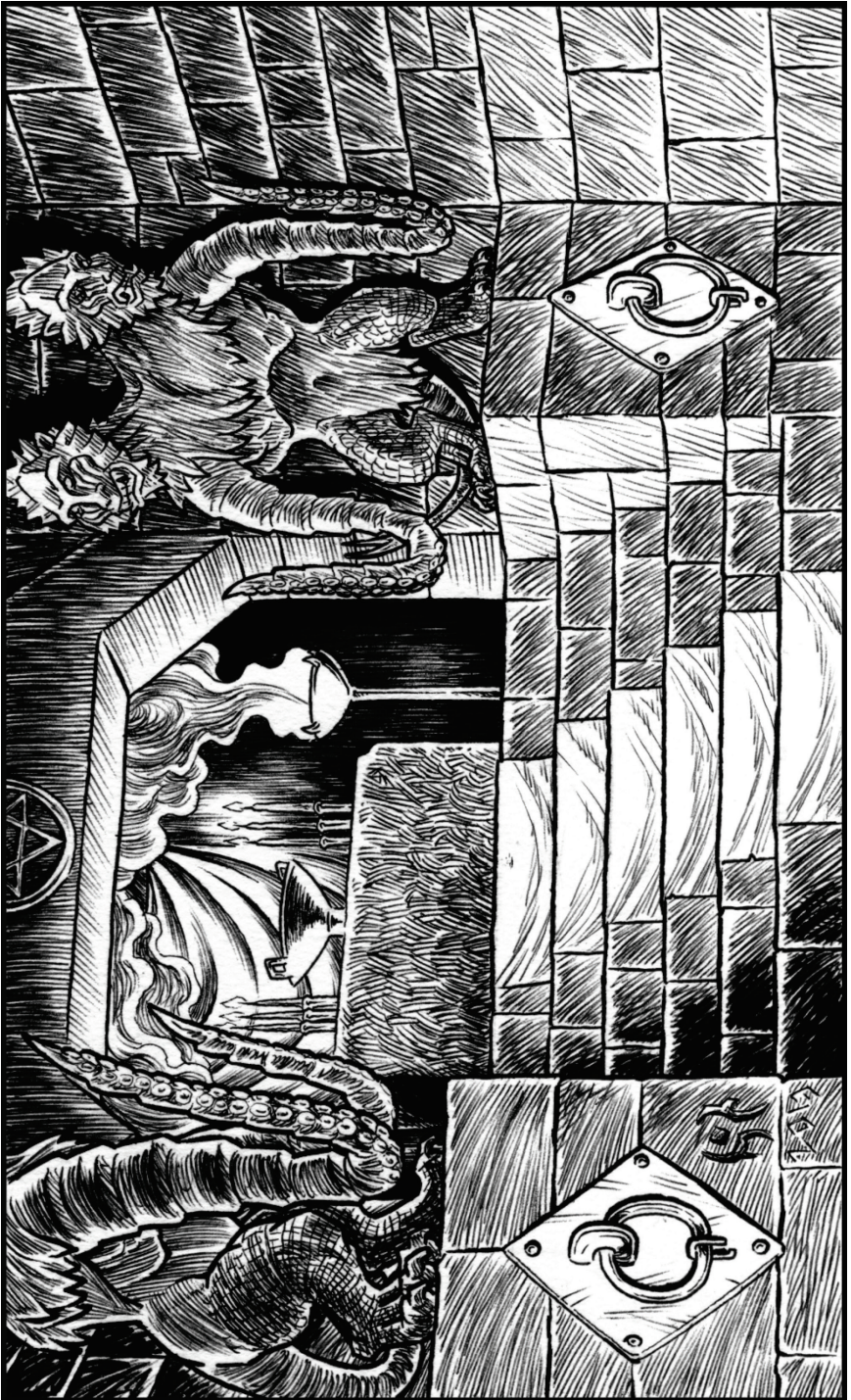

Illustration 6

Castle of the Mad Archmage

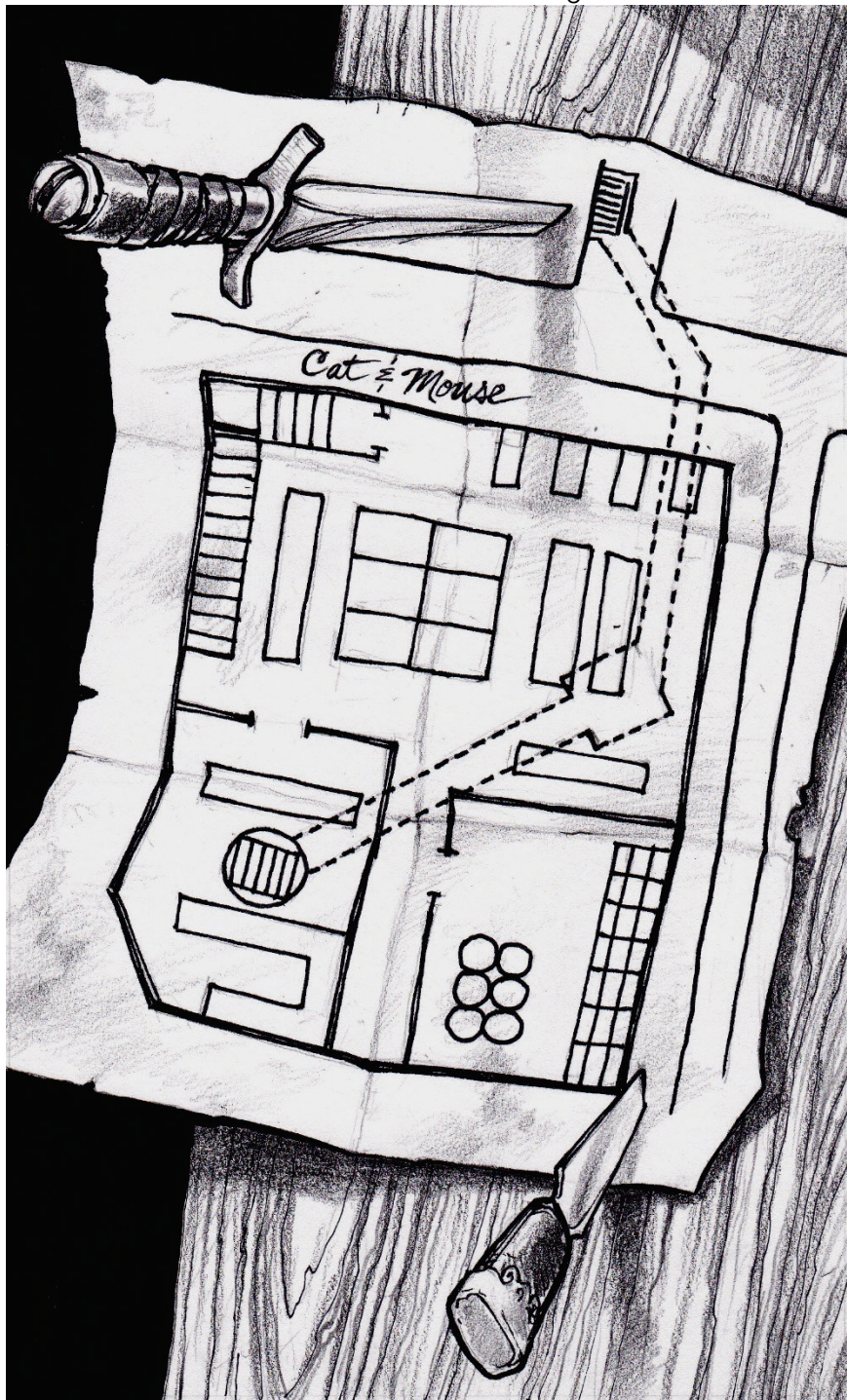

Illustration 7

Castle of the Mad Archmage



Illustration 8

Castle of the Mad Archmage

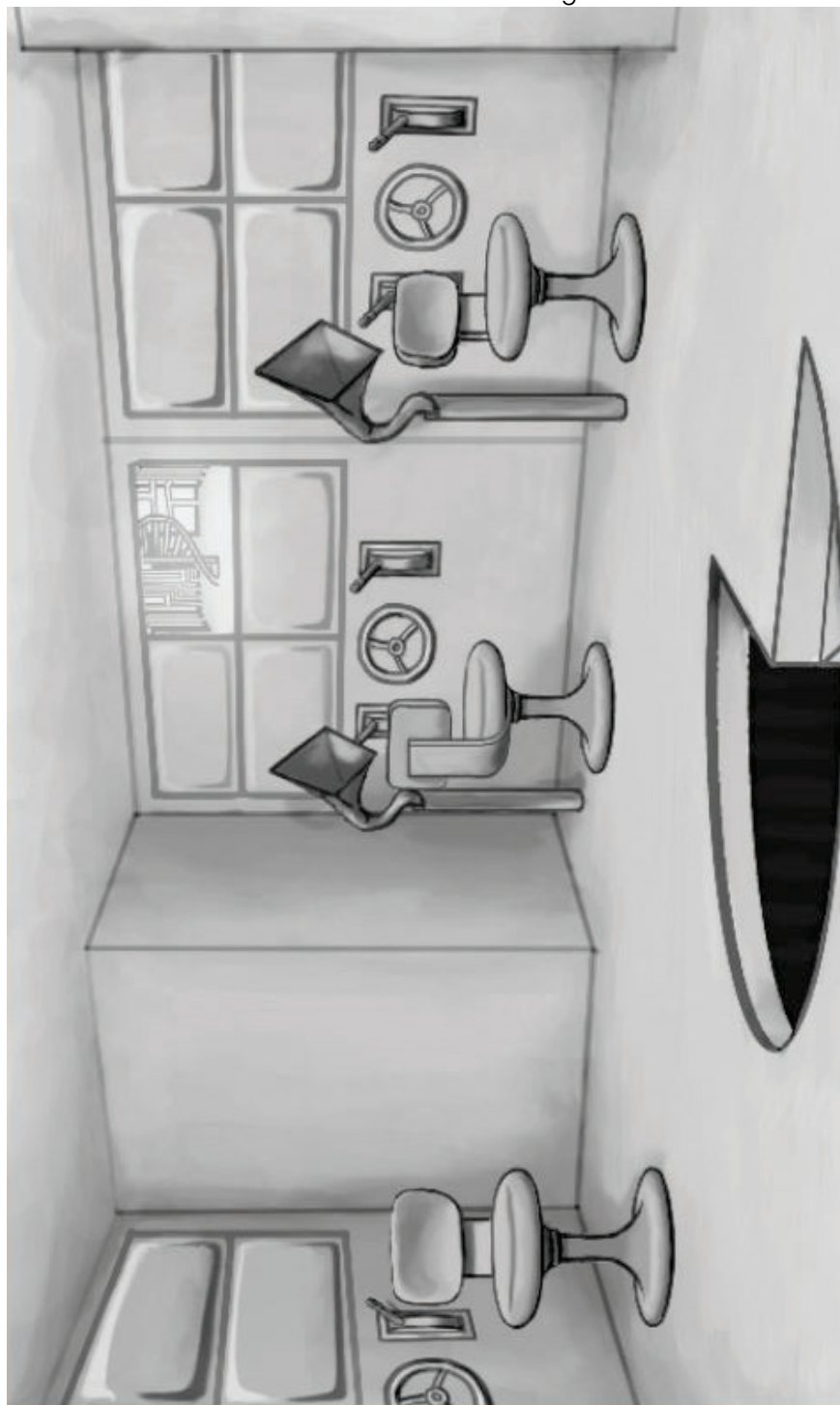

Illustration 9

Castle of the Mad Archmage

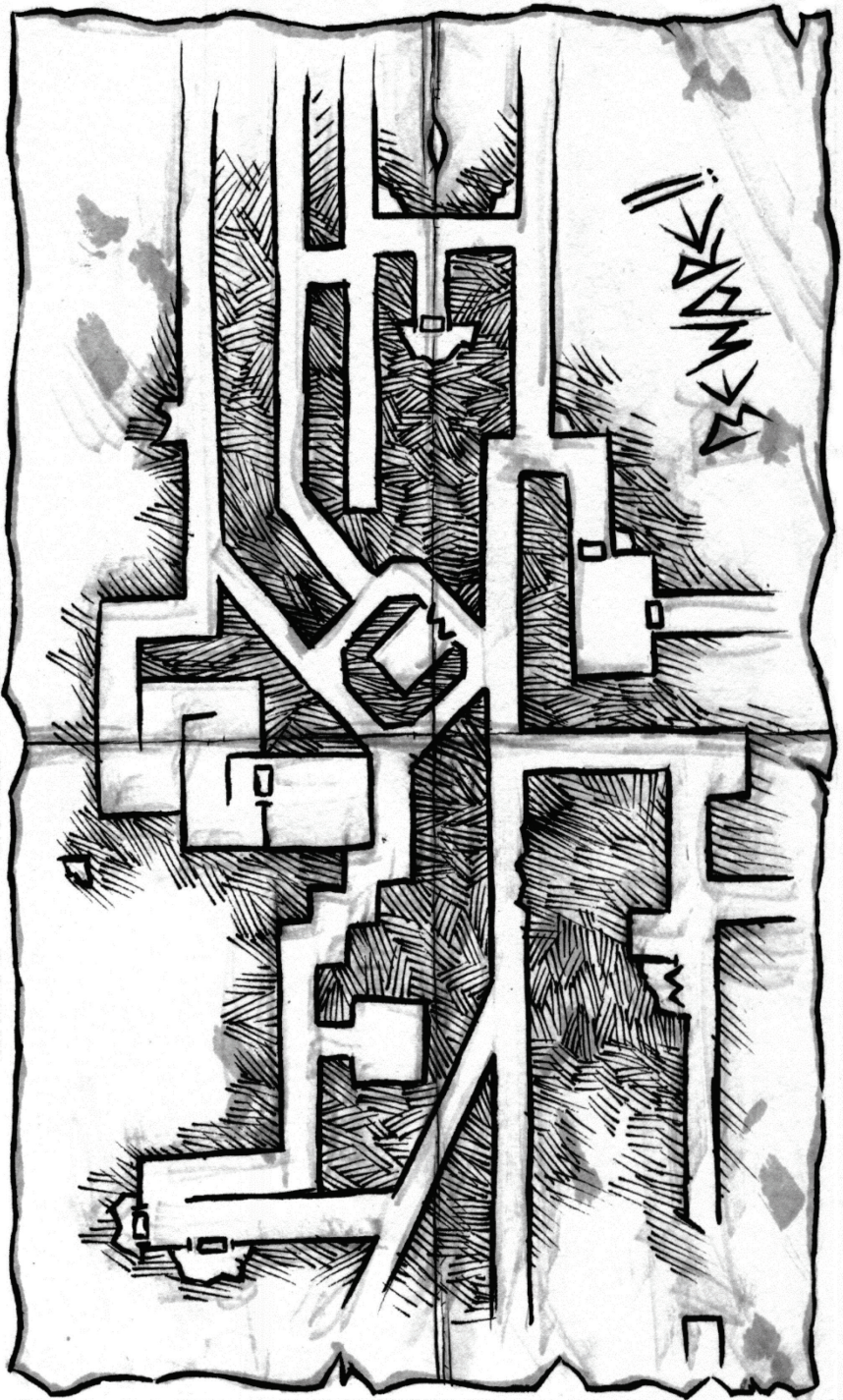

Illustration 10

Castle of the Mad Archmage



Illustration 11

Castle of the Mad Archmage

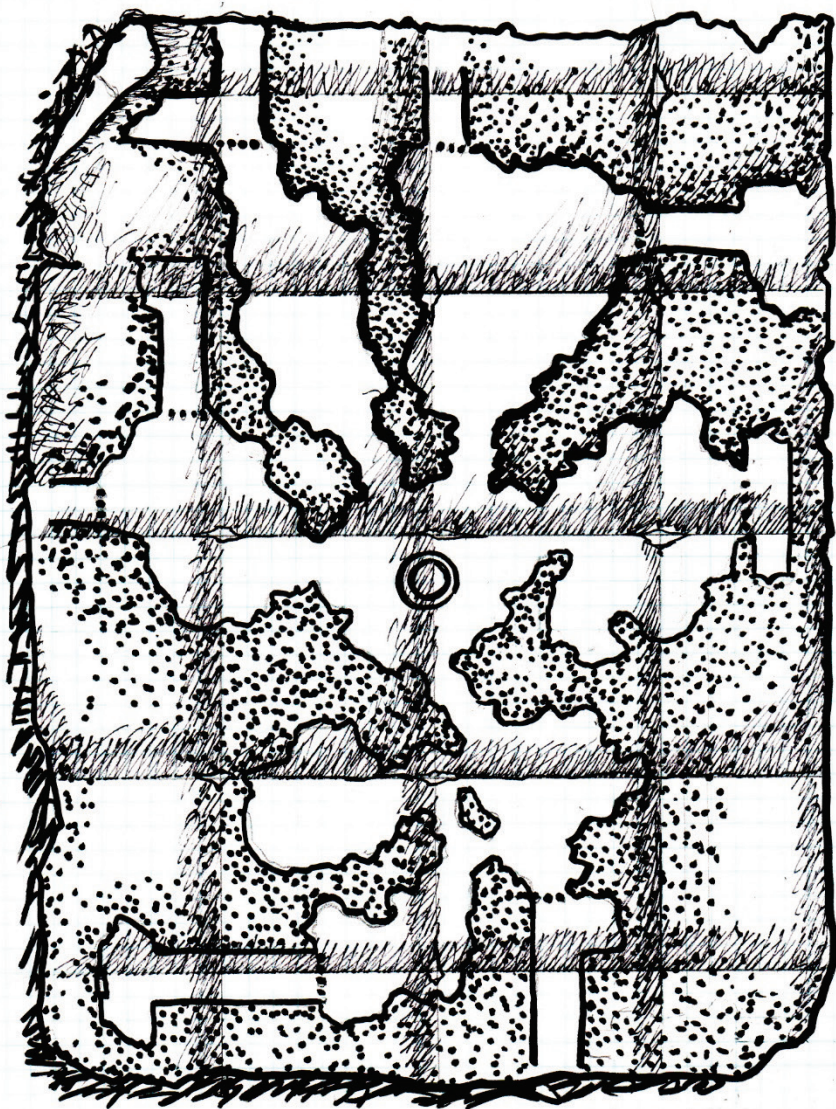

Illustration 12

Castle of the Mad Archmage



Illustration 13

Castle of the Mad Archmage



Illustration 14

Castle of the Mad Archmage

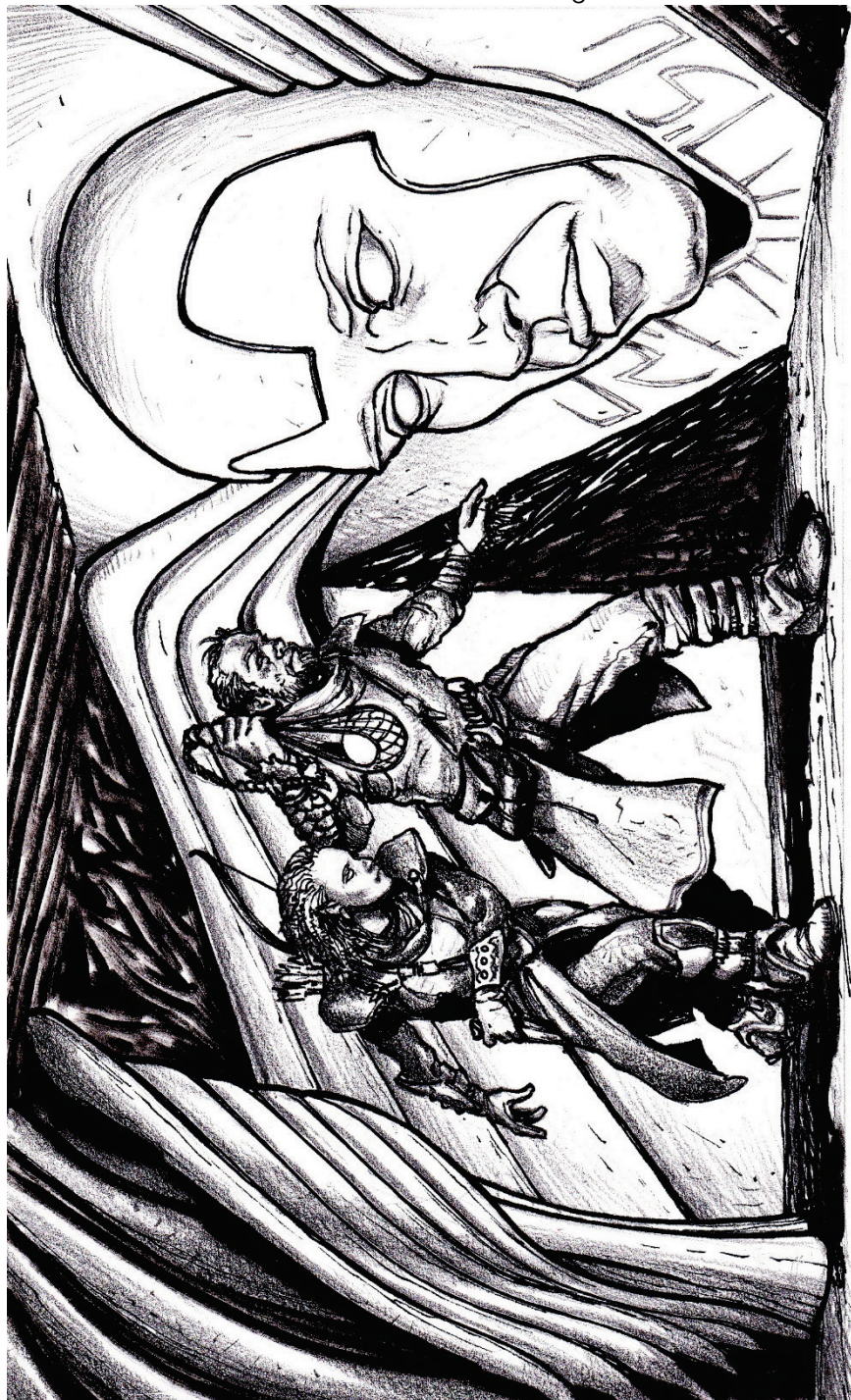

Illustration 15

Castle of the Mad Archmage

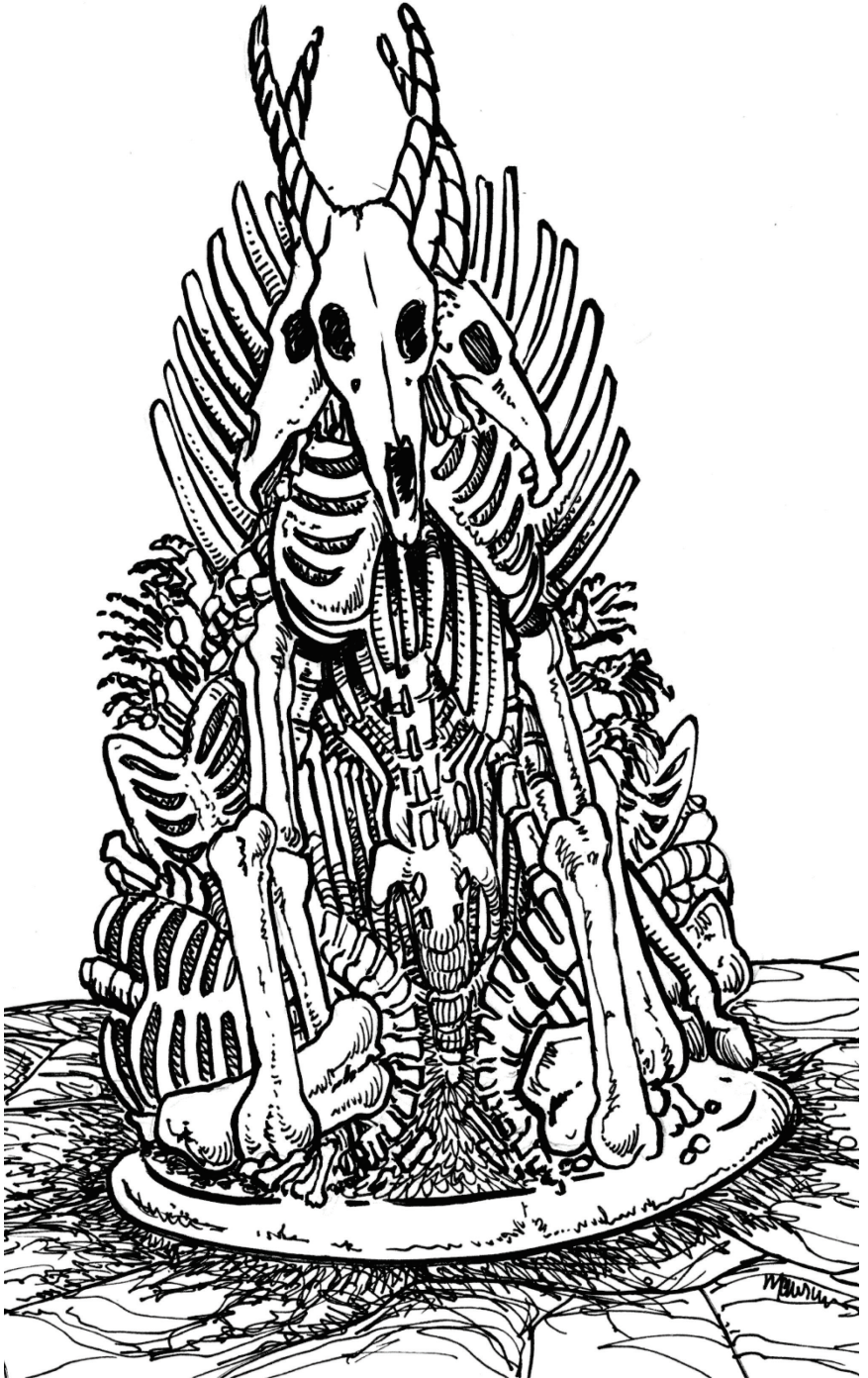

Illustration 16

Castle of the Mad Archmage



Illustration 17

Castle of the Mad Archmage



Illustration 18

Castle of the Mad Archmage



Illustration 19

Castle of the Mad Archmage



Illustration 20

Castle of the Mad Archmage



Fil Kearney 2013

Illustration 21

Castle of the Mad Archmage

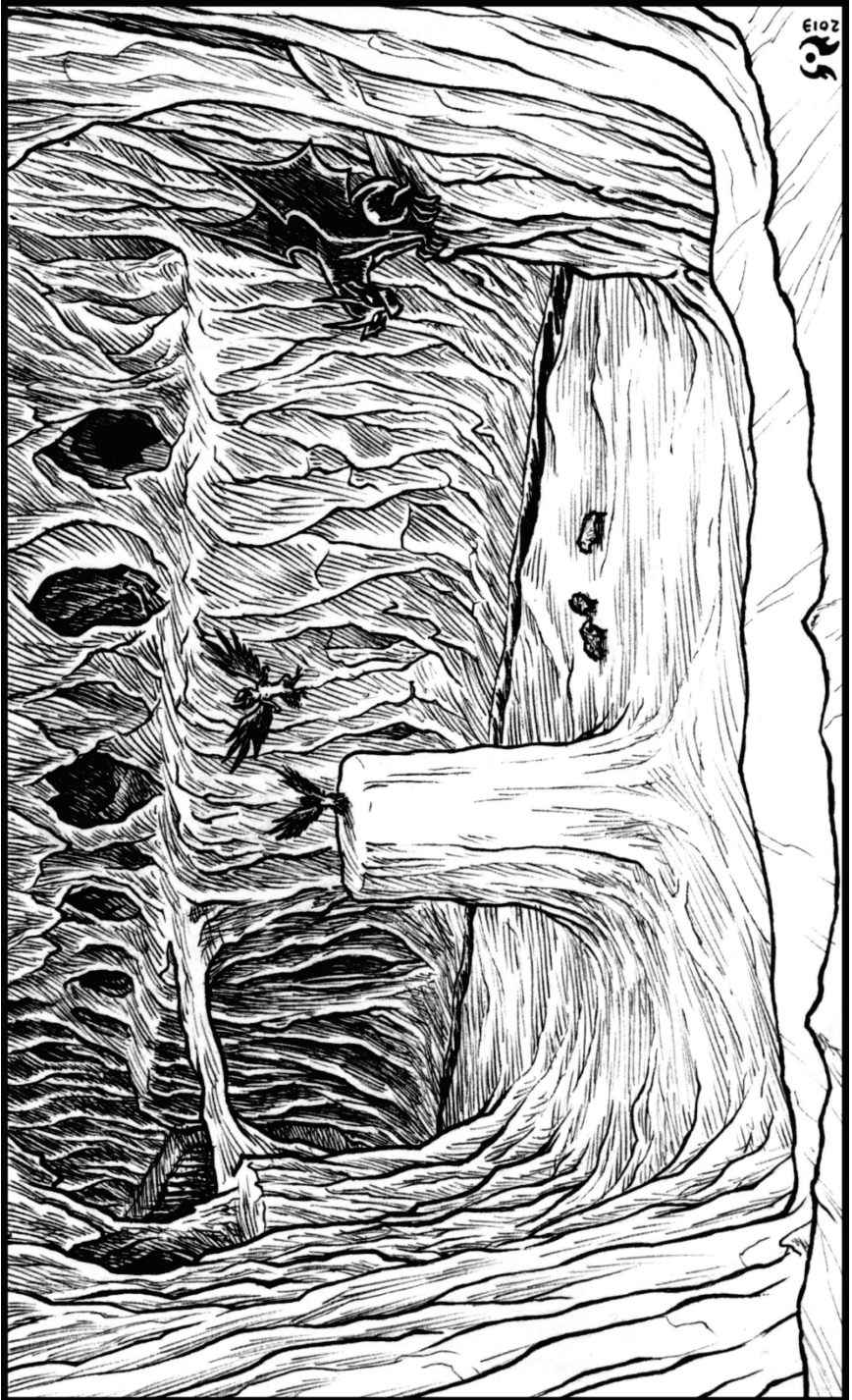

102
5

Illustration 22

Castle of the Mad Archmage



Illustration 23

Castle of the Mad Archmage



Illustration 24

Castle of the Mad Archmage

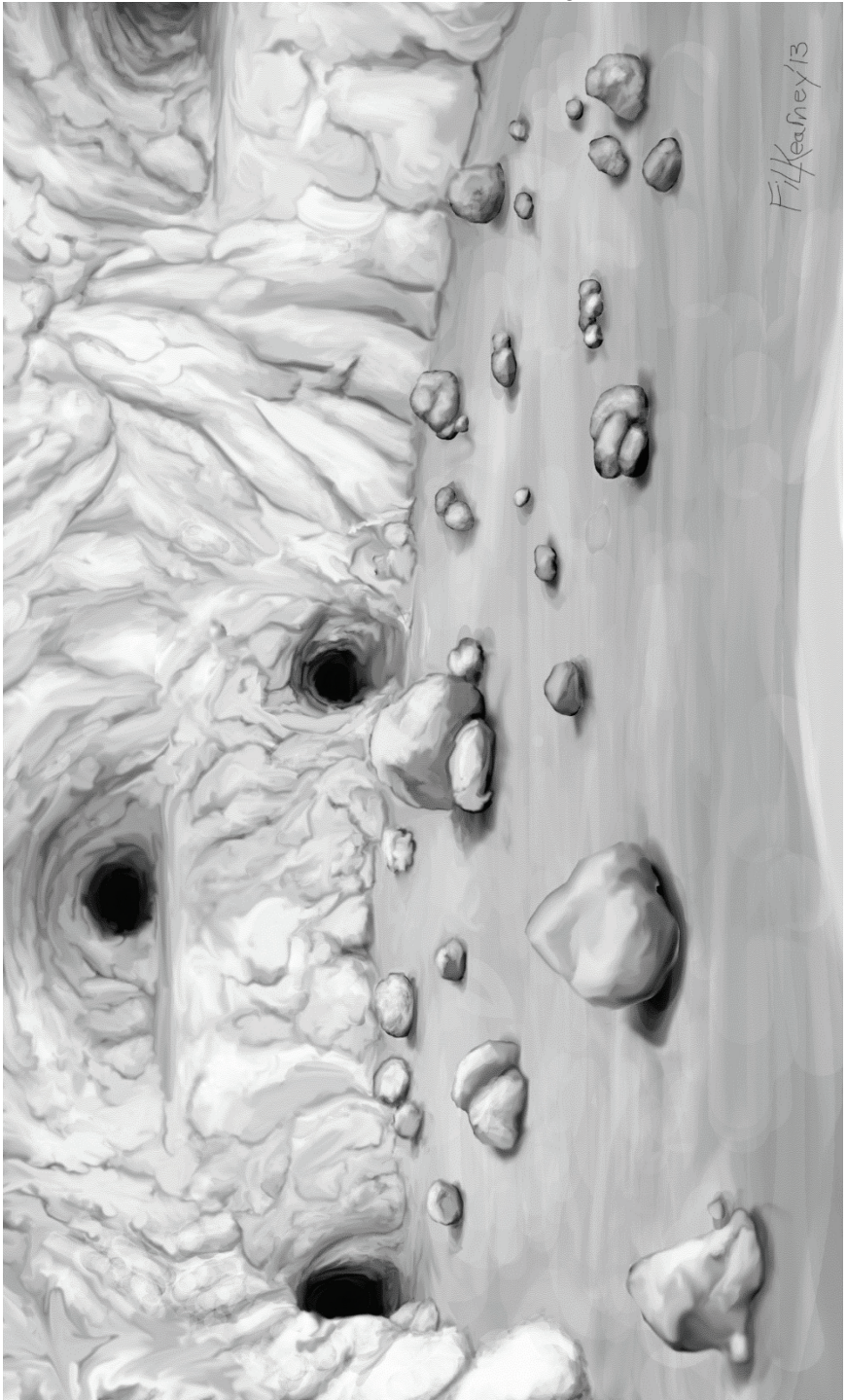

Illustration 25

Castle of the Mad Archmage

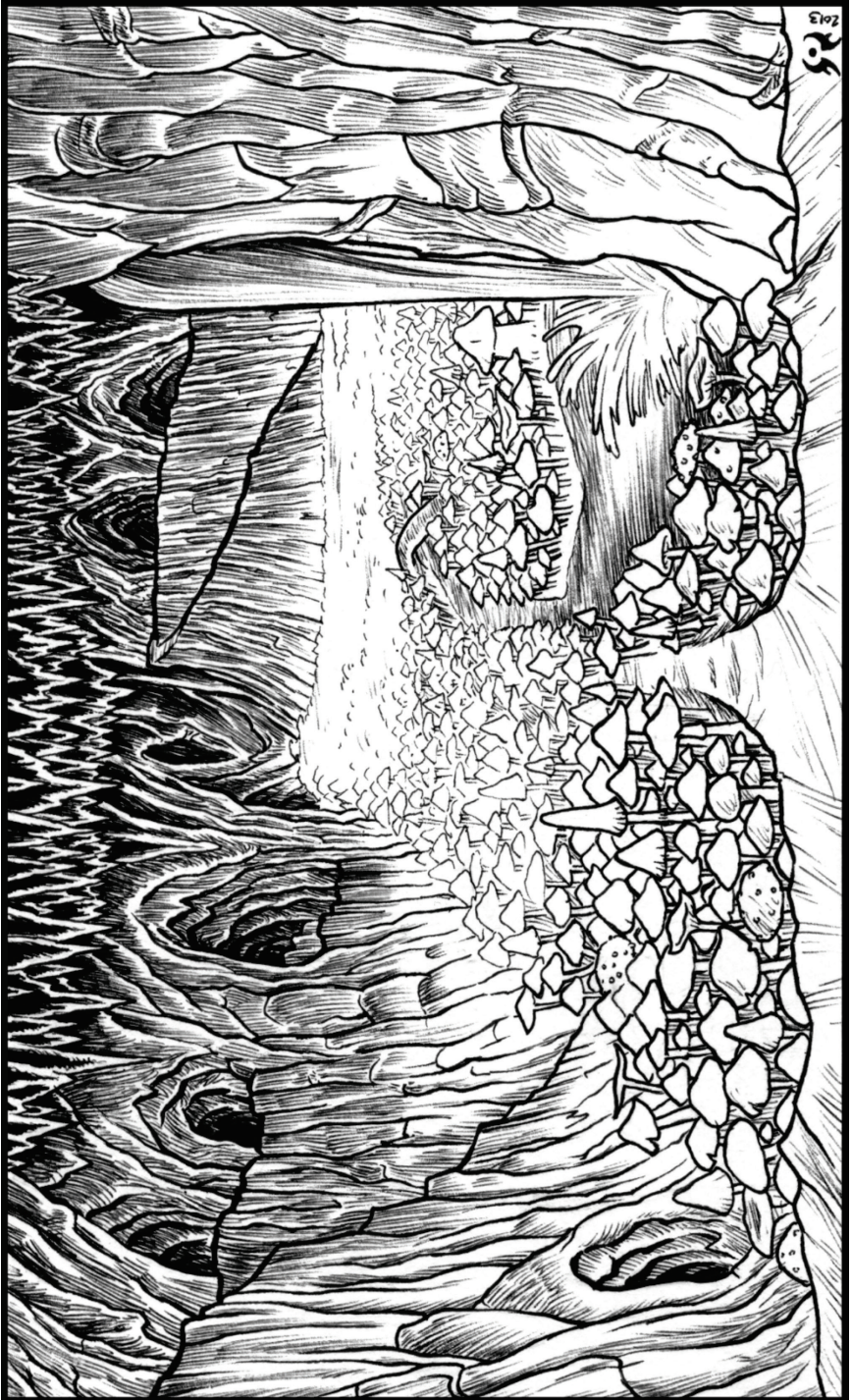

Illustration 26

Castle of the Mad Archmage



Illustration 27

Castle of the Mad Archmage



Illustration 28

Castle of the Mad Archmage



Illustration 29

Castle of the Mad Archmage



Illustration 30

